

WaBee Complete Wireframes

Home

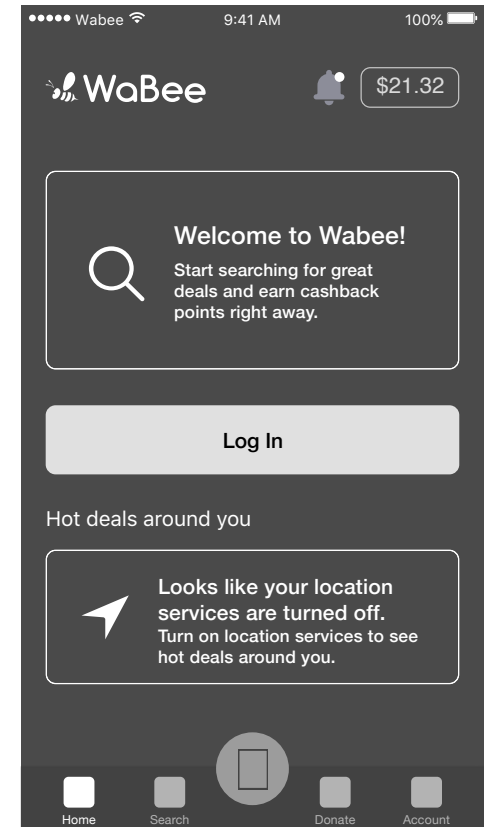

Search / Location Services On / List View

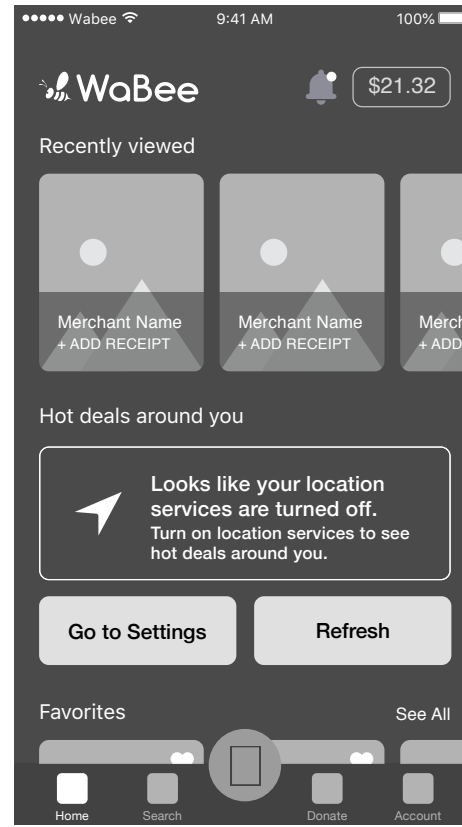
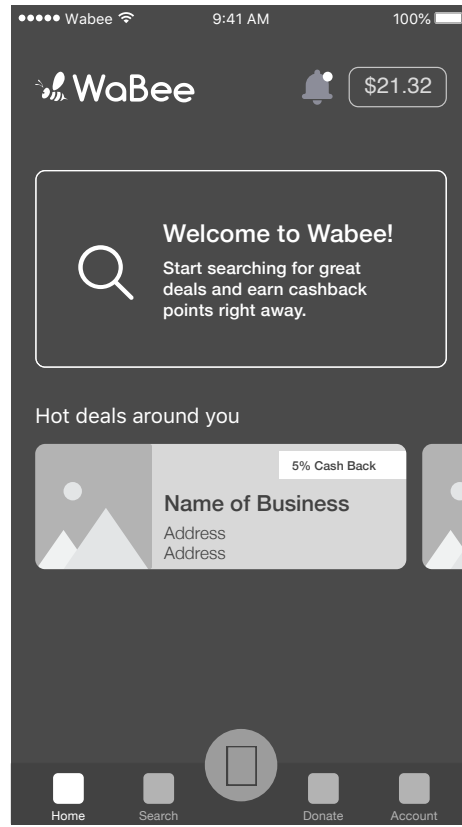
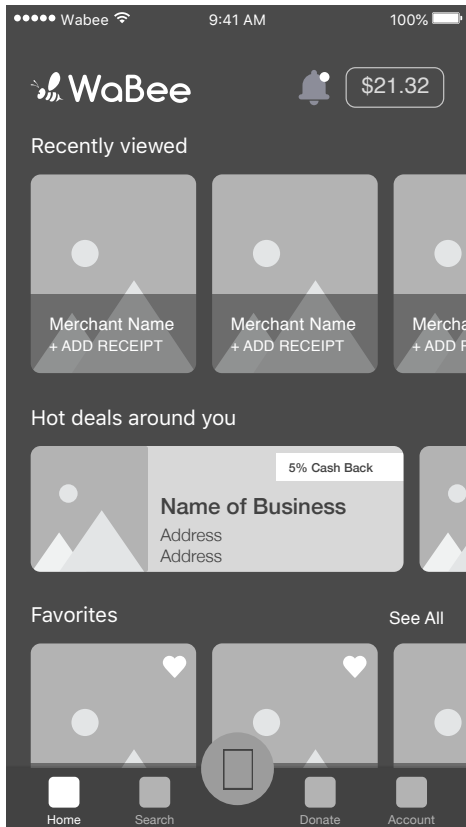
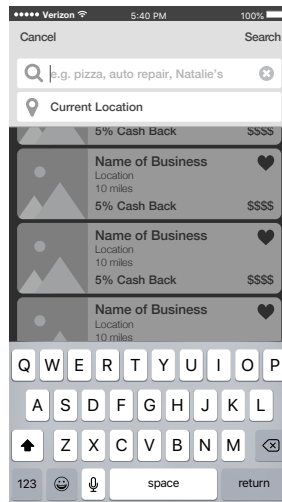
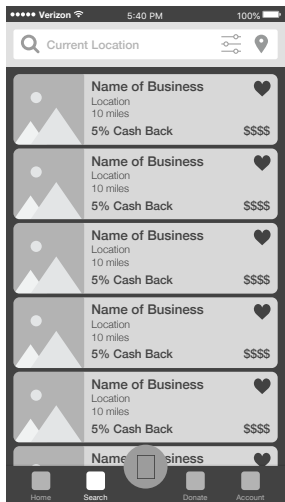

Search drops down as overlay

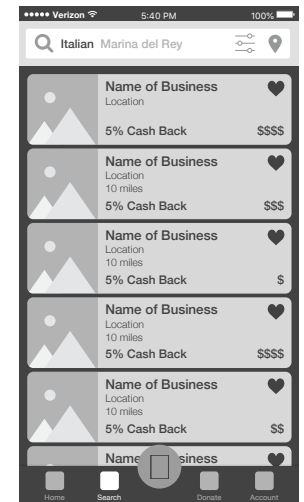
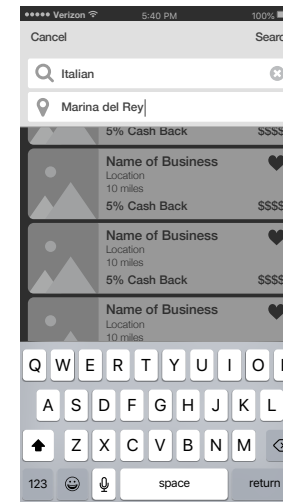
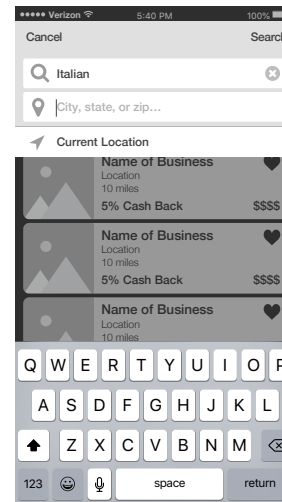
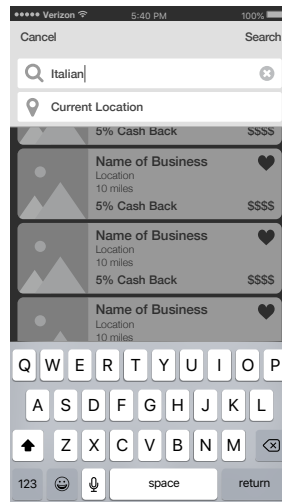

Location services ON - location field defaults to last location searched (if it's the first time, "current location" is the default)

Search / Location Services On / Map View

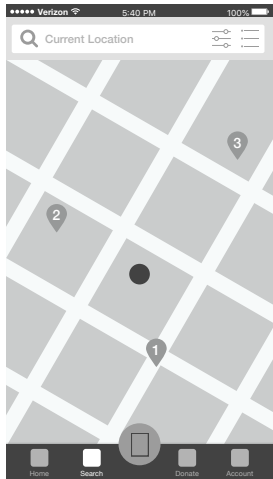

Location services ON - map defaults to last location searched (if it's the first time, "current location" is the default)
Dot = user's location
Numbers = sort order

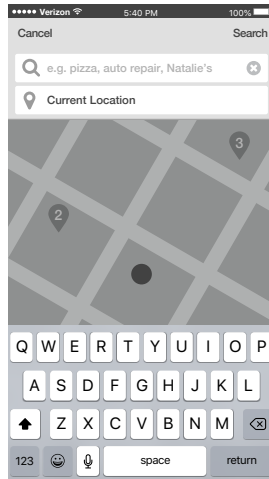

Sort and map/list options disappear while searching
"X" icon to delete search text
Location defaults to Current Location until user taps field

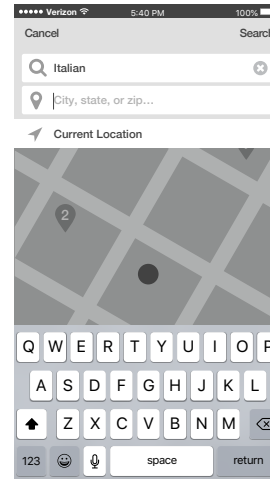
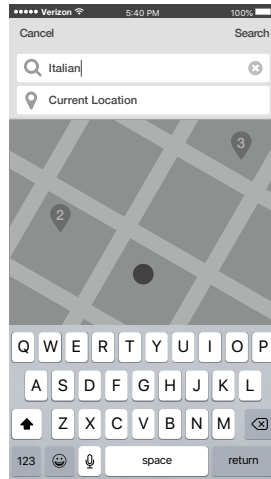

If location is set to "current location":
when user taps field, "city, state, or zip" instructional text appears with cursor.
"Current Location" appears underneath as an option until user starts typing

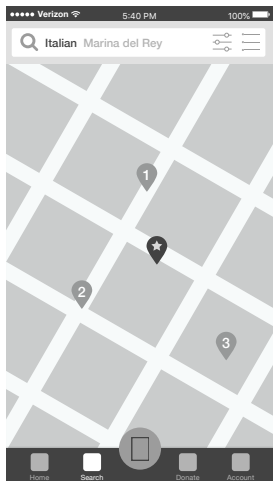
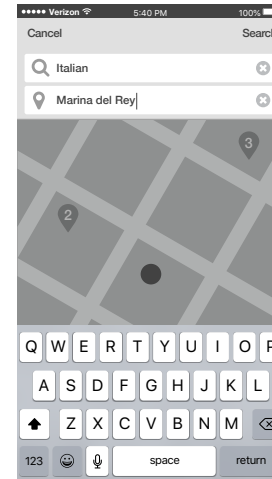

Special location marker to show the location the user searched (if not current location)

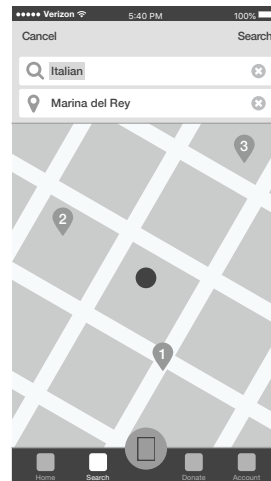
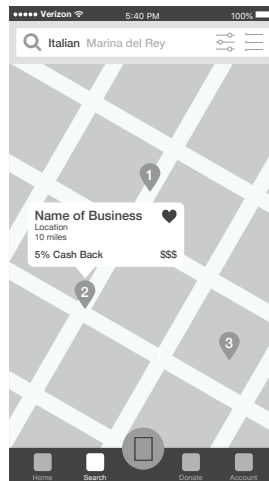

User-entered text is automatically highlighted when user taps on either field

Search / Location Services Off / List View

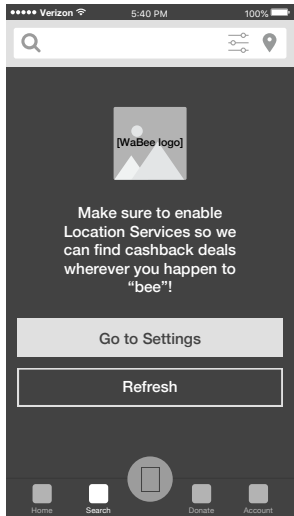

Location services OFF view for first time users. List View is default. Search field is blank.

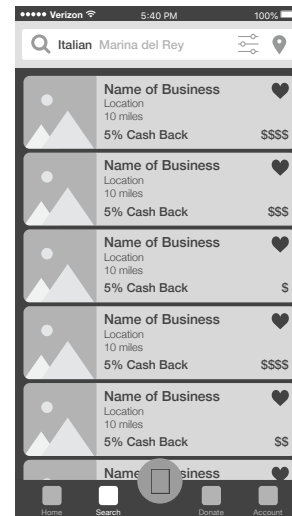
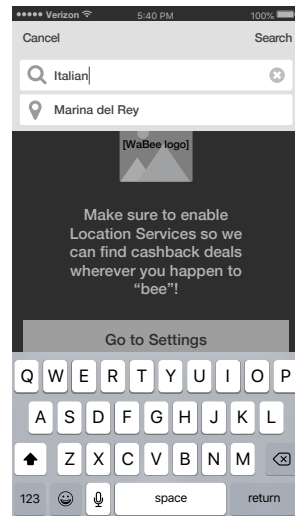
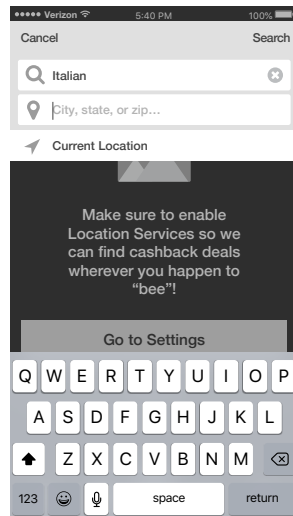
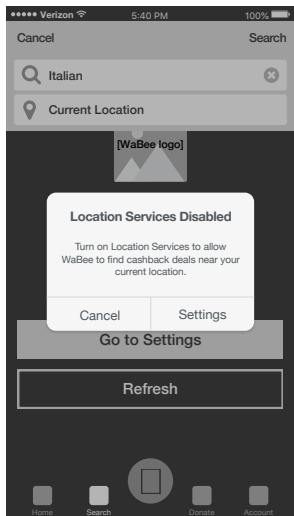
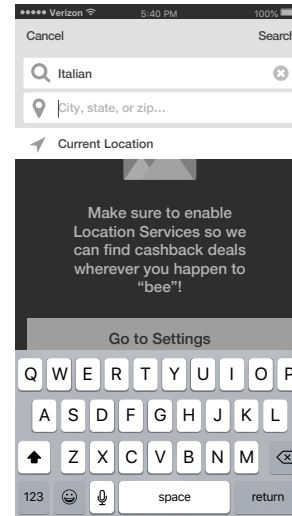
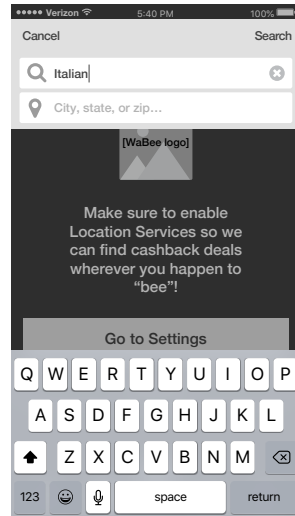
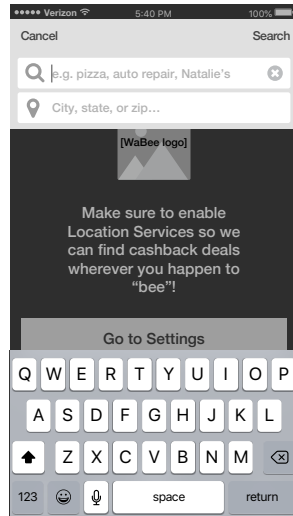

Search / Location Services Off / Map View



Location services OFF - if a user goes to map view before searching, the default map shows & search field is blank

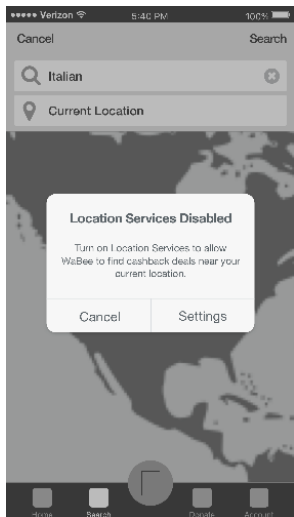
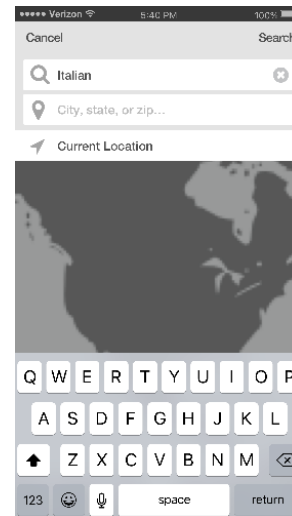
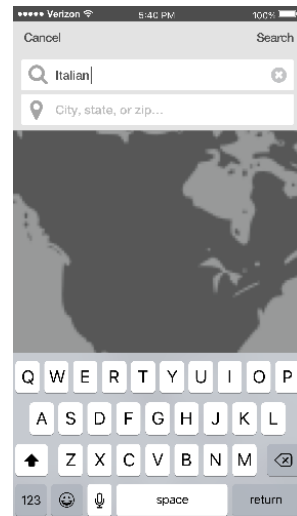
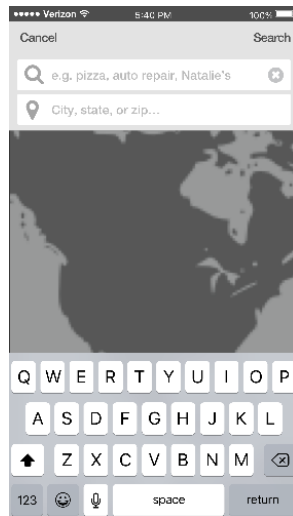

If user taps "current location" they get an error message

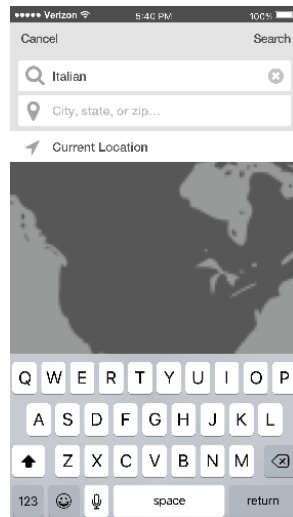

After choosing "cancel" on the error message - back to the same screen

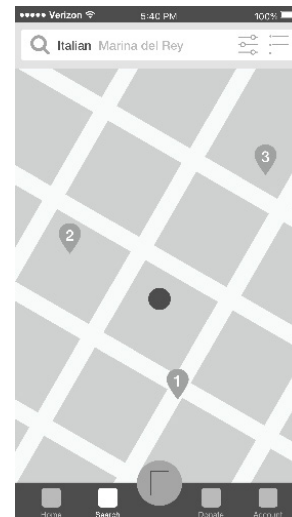
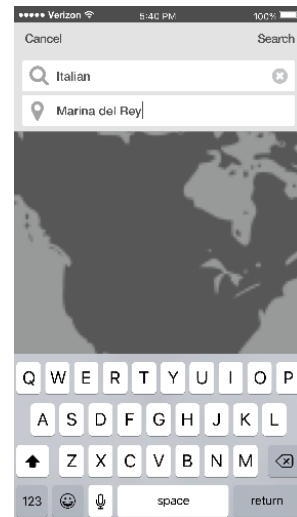

Search / Sort Menu

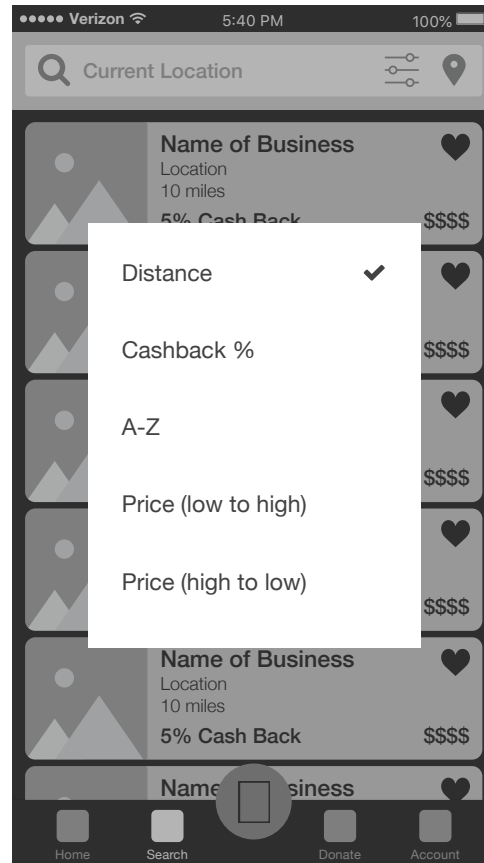
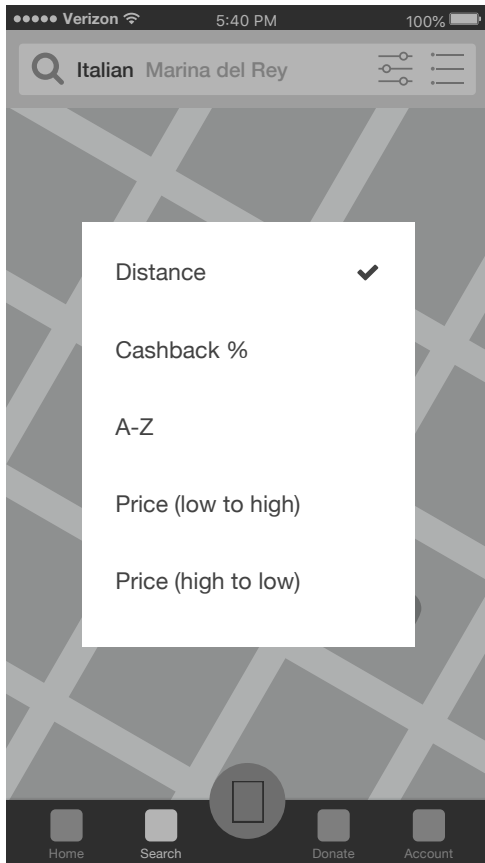

Default sort is “distance”. User can tap outside the pop up to dismiss it.

Merchant Details (1)

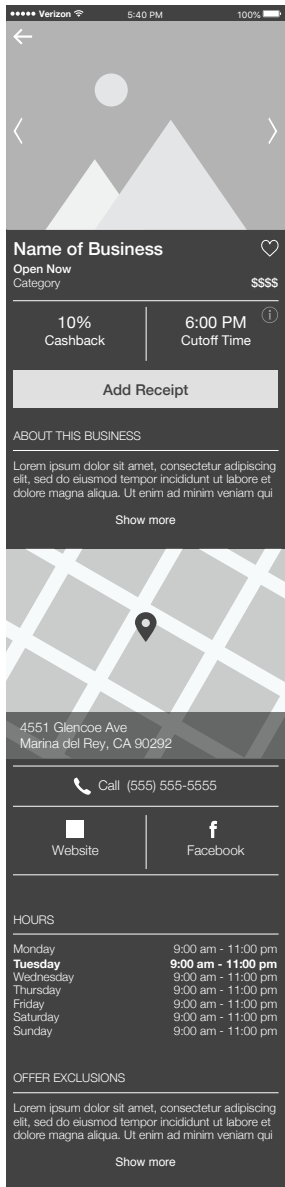

"Open Now" changes to "closed" if closed or "closing soon" if the merchant will close within 1 hr - color should be different for "open now" than for the other two

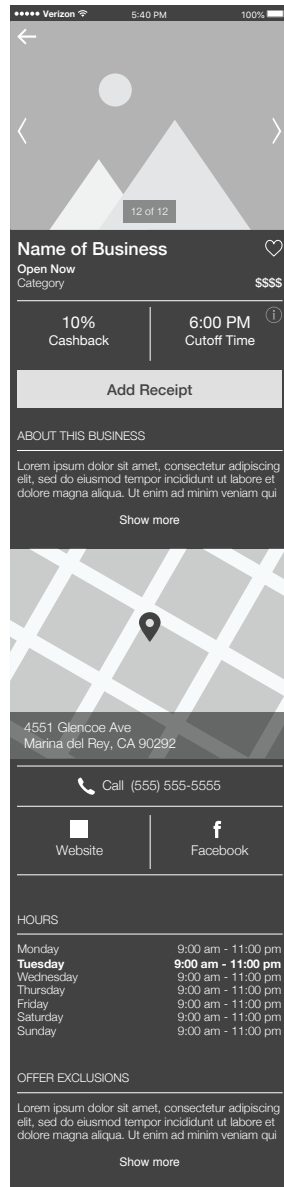
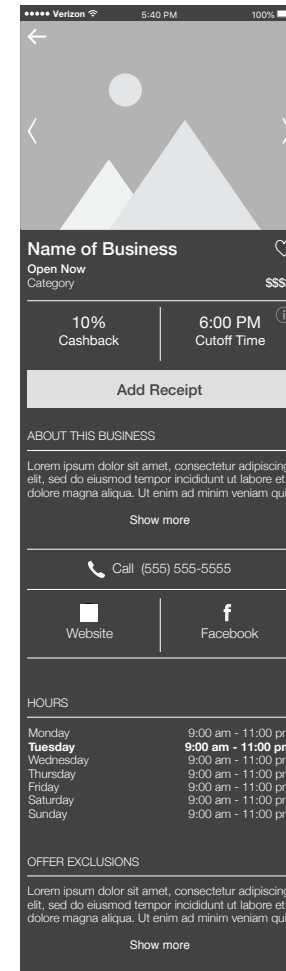
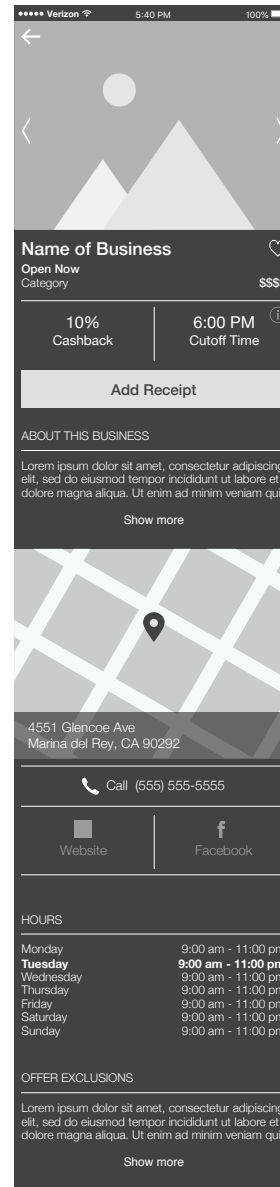
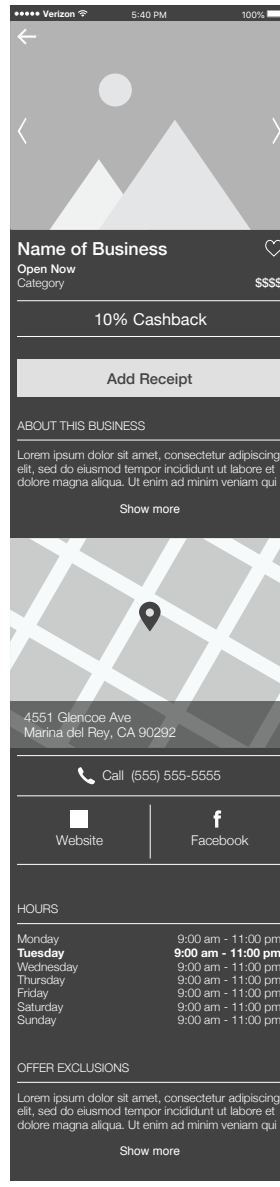
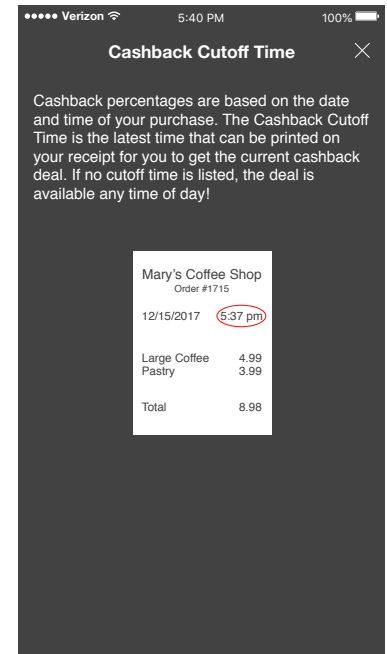
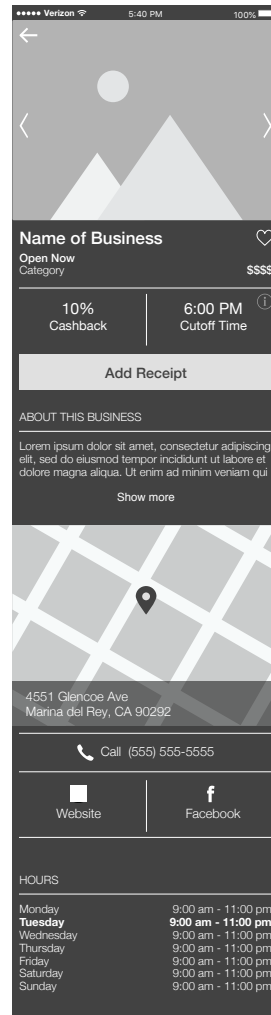
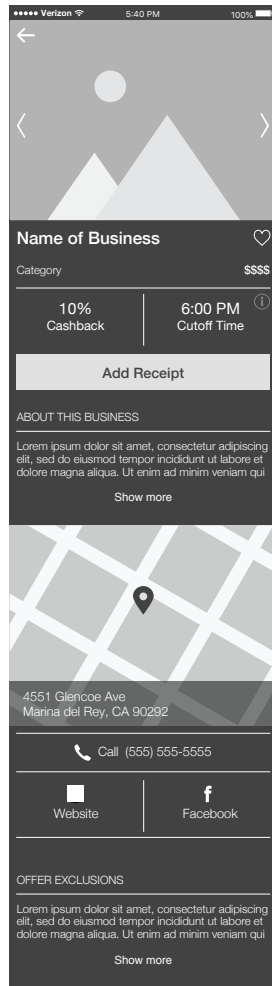
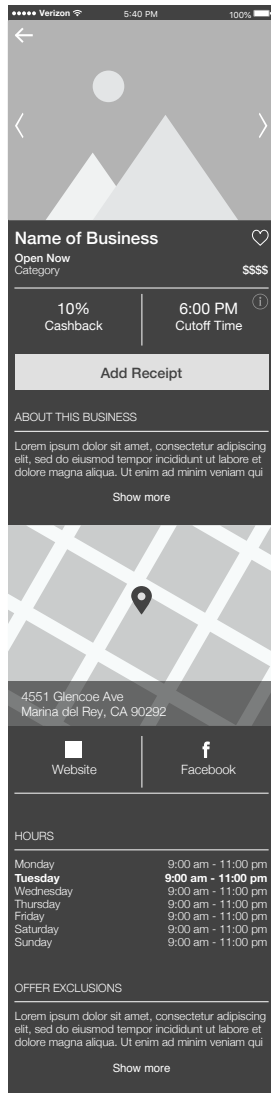
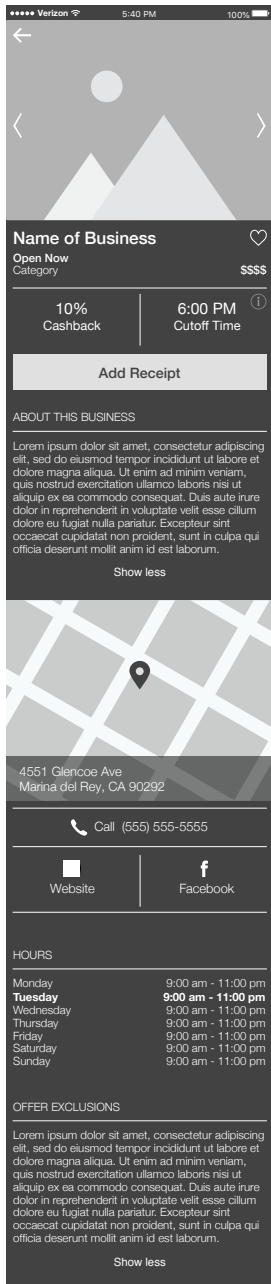

Photo number only appears on 2nd photo or later
Carousel should scroll on a continuous loop



Merchant Details (2)



Donate / Location Services On

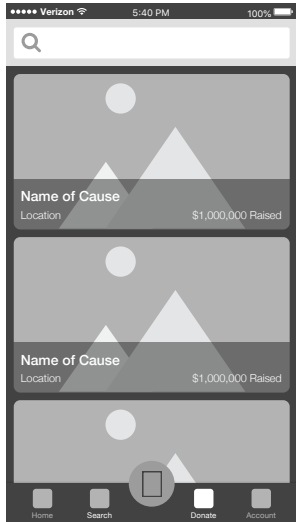

Default sort is amount raised

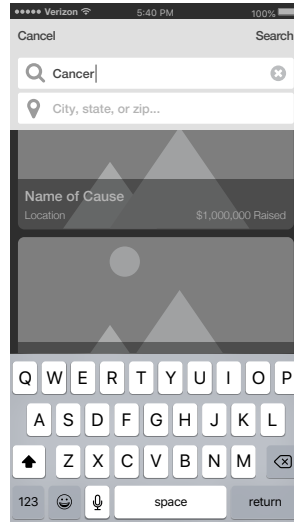
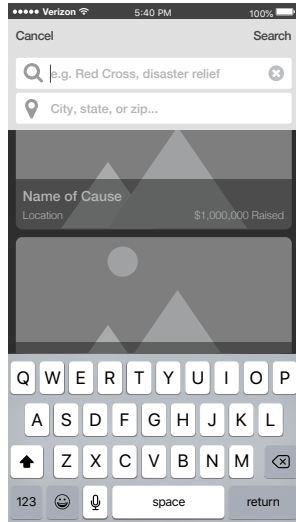

User does not have to fill out both fields
If location field is not filled out, the search will return results from all locations
If "name or category" is not filled out, the search will return all results from the specified location

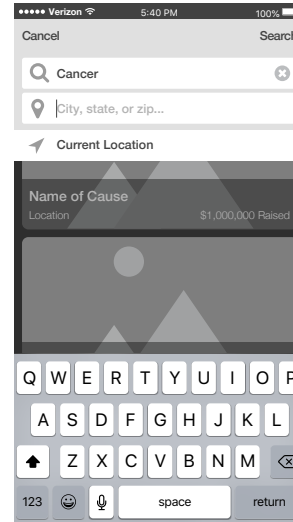

Current Location is listed as an option when user taps the location field

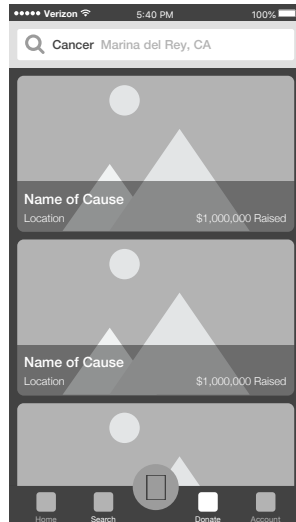
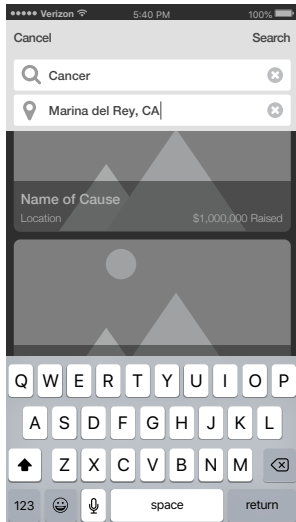

If a location is entered, results are sorted by distance. If no location is entered, results are sorted A-Z

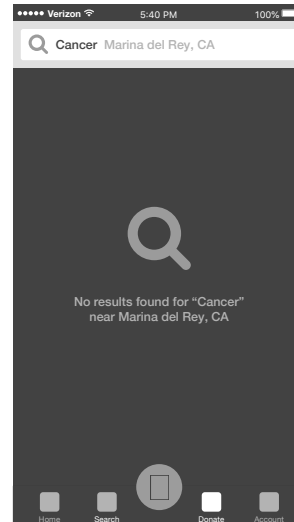

Donate / Location Services Off

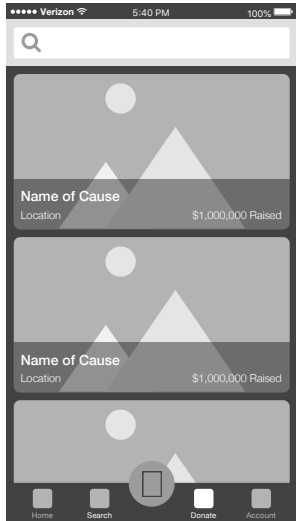

Defaults to featured list of causes, search field is blank

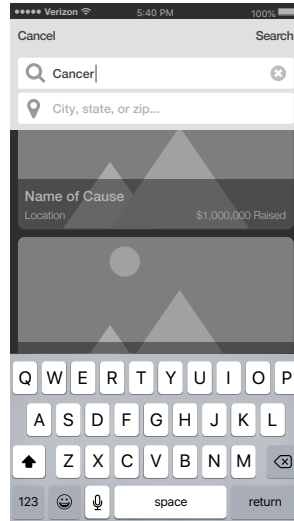
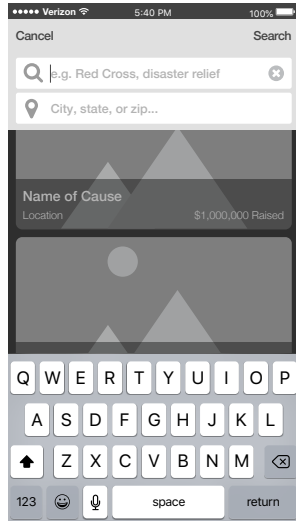

User does not have to fill out both fields
If location field is not filled out, the search will return results from all locations
If "name or category" is not filled out, the search will return all results from the specified location

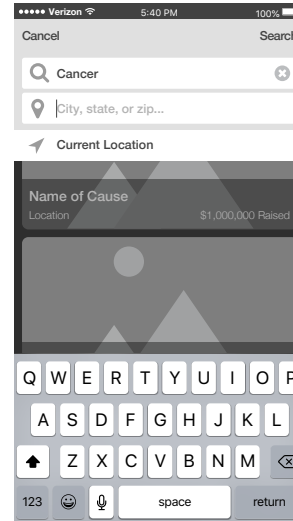

Current Location is listed as an option when user taps the location field

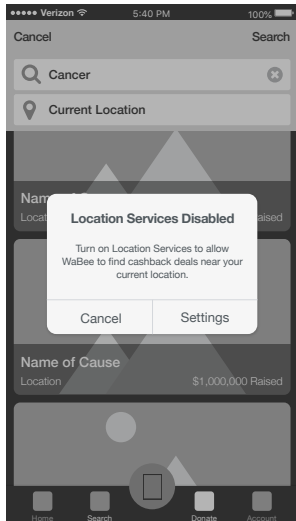

If user taps "current location" they get an error message

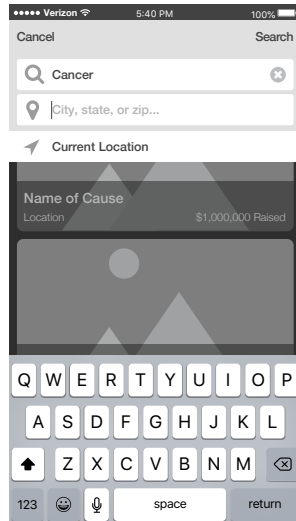

After choosing "cancel" on the error message - back to the same screen

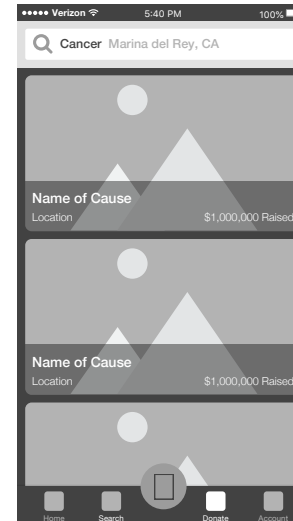
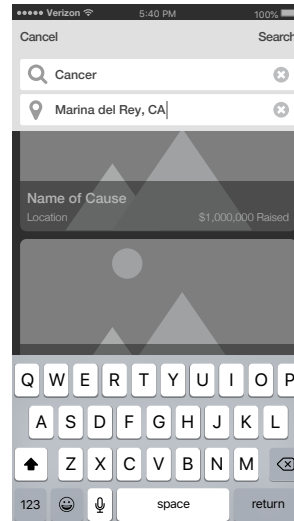

If a location is entered, results are sorted by distance. If no location is entered, results are sorted A-Z

Donate / Organization Detail

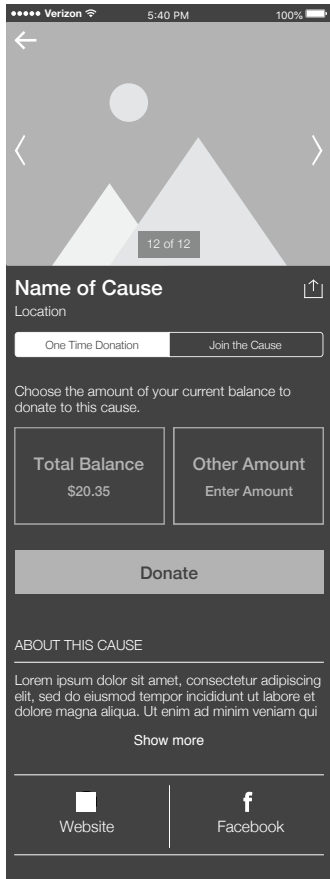
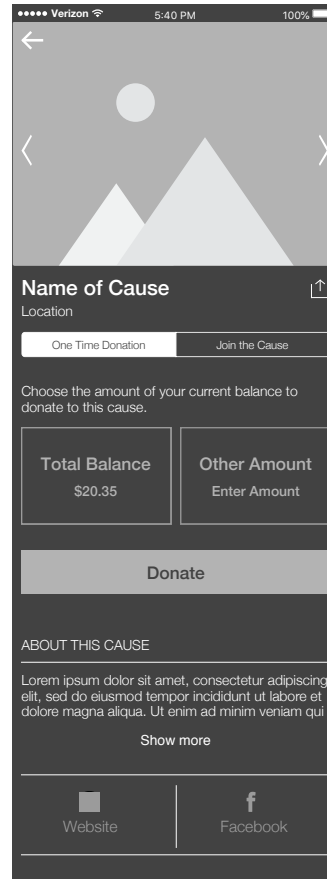
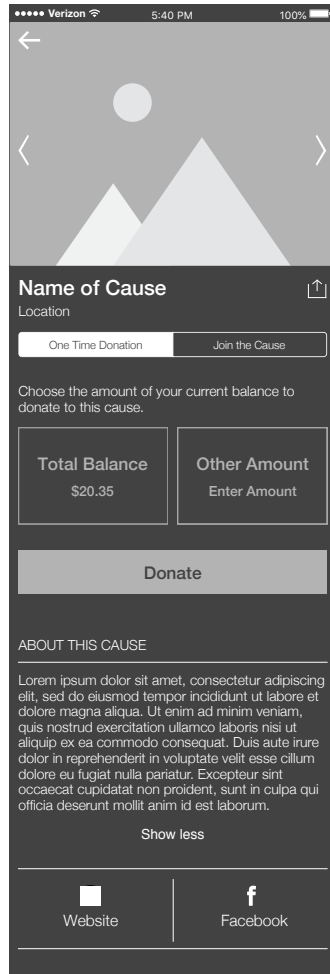
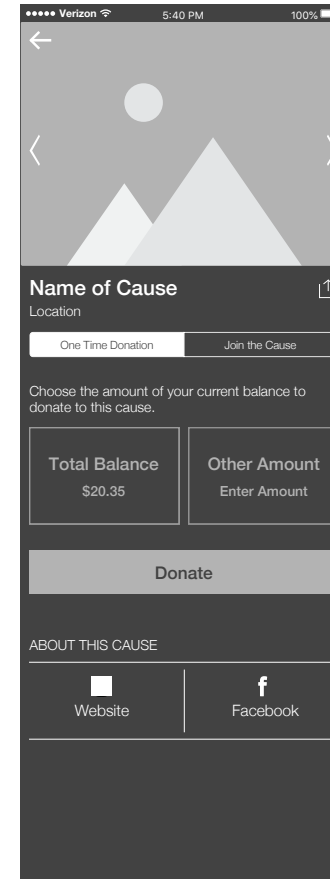

Photo number only appears on 2nd photo or later



If the cause does not have a website or Facebook, they are greyed out



If the cause does not have "about" text

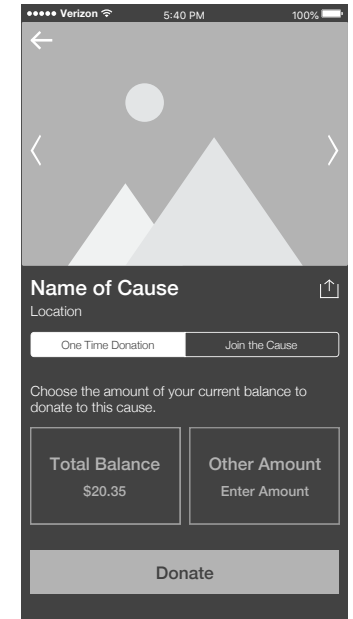

If the cause does not have "about" text or website/Facebook

Donate / One Time Donation

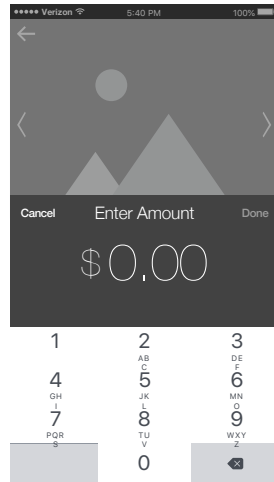
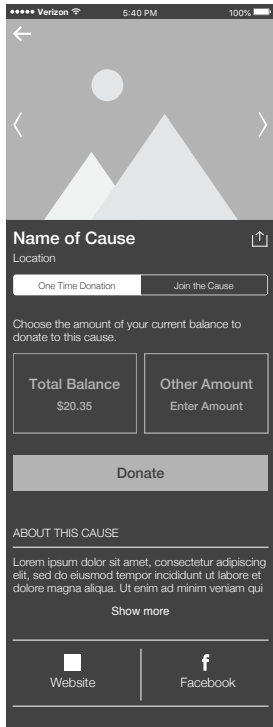

If user taps "other amount", the number keyboard automatically comes up

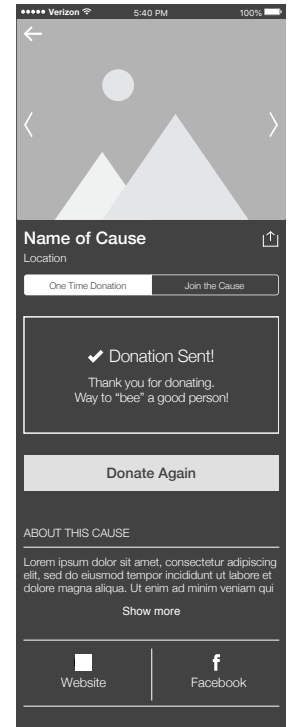
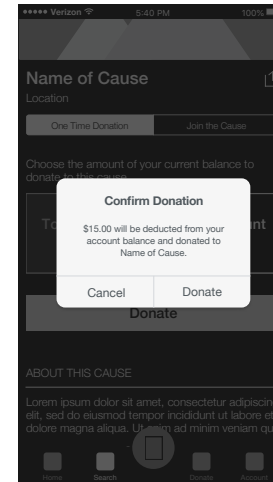
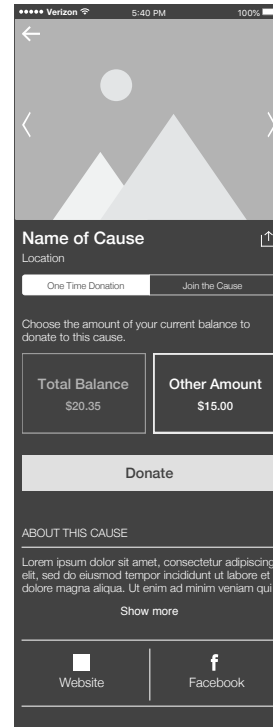
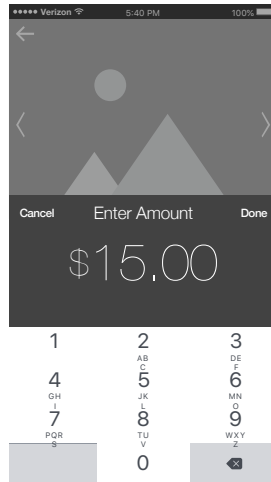

Tapping "donate again" would take the user back to the first screen

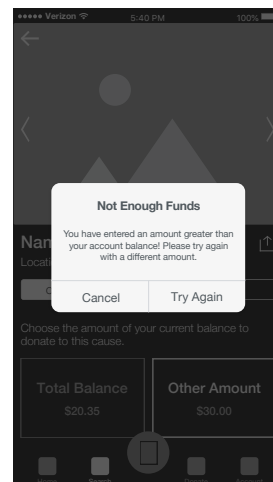

Donate / Join the Cause

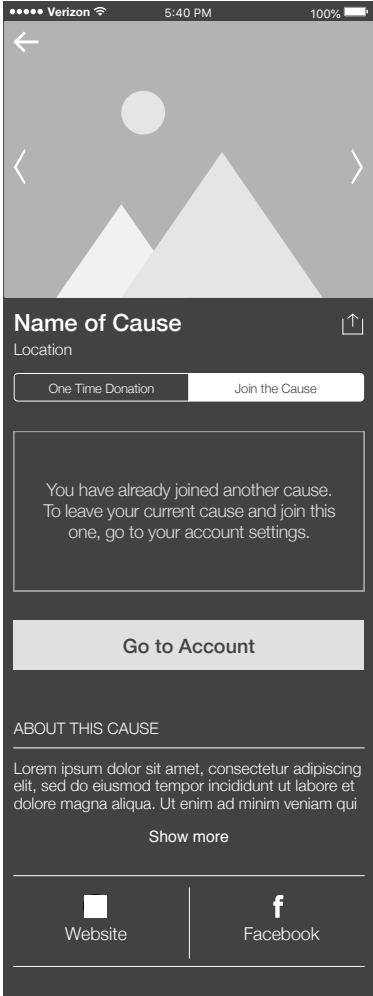
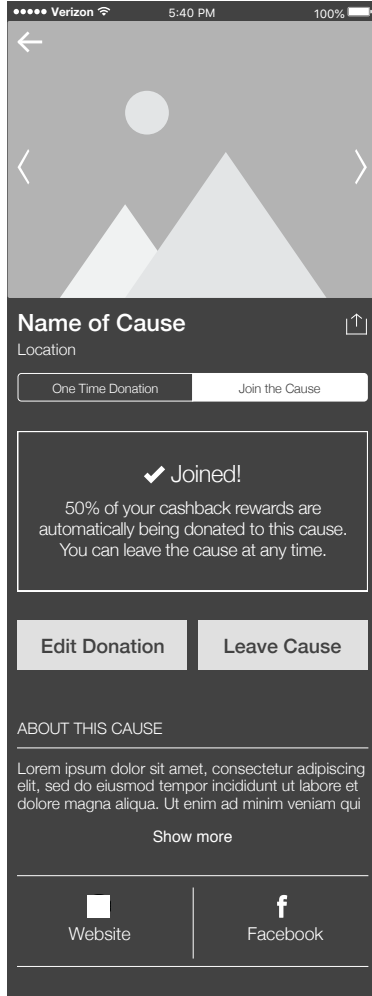
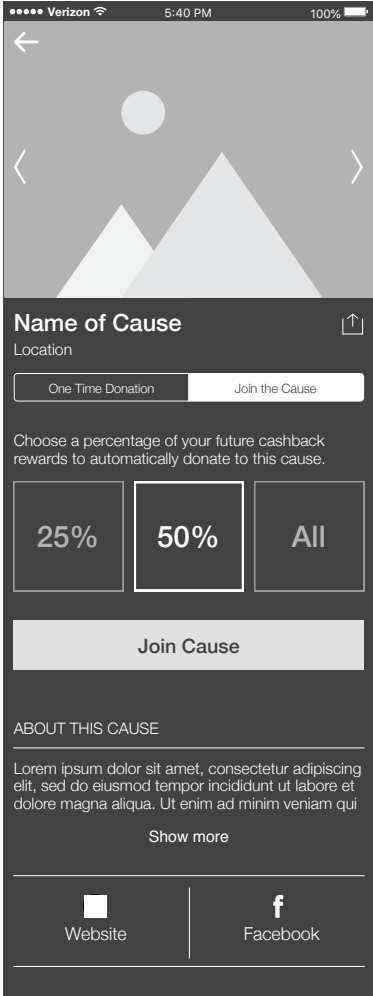

If the user is joined to another cause, all other causes will look like this. Tapping "Go to Account" takes the user to the account section.

Donate / Edit Donation %

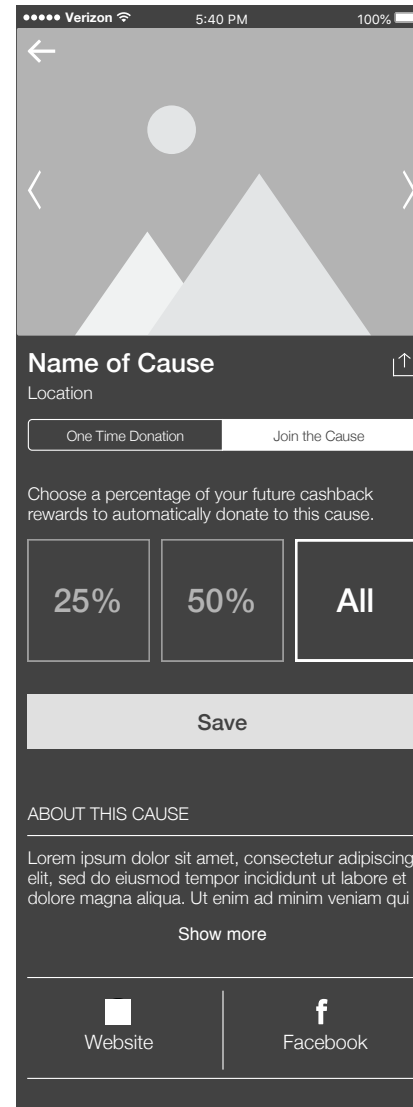
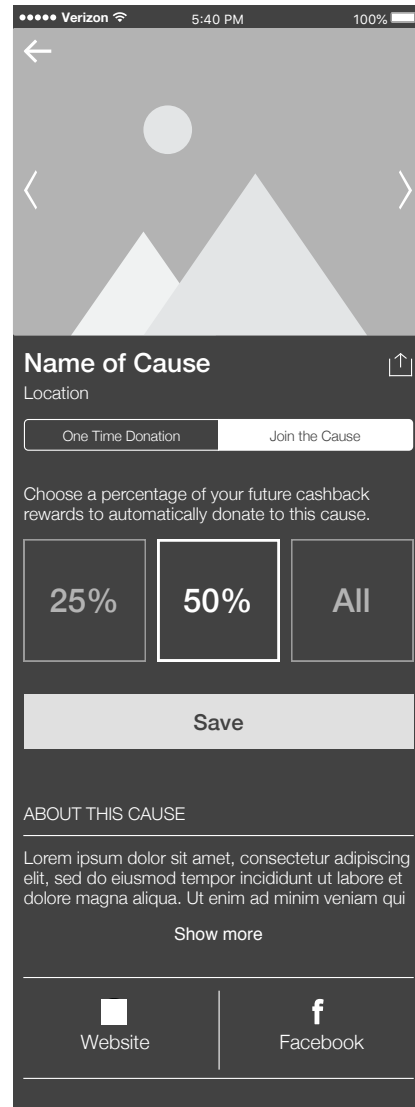

The user's current donation amount is selected
If the user leaves this screen without doing anything, their current donation remains the same.

Balance

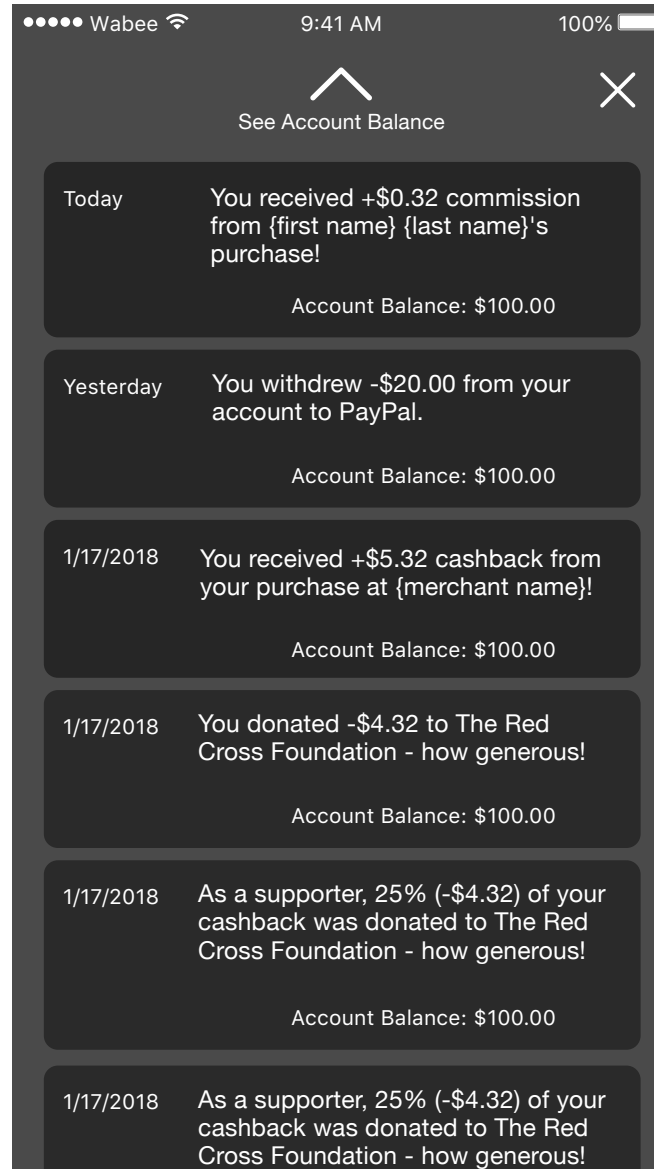
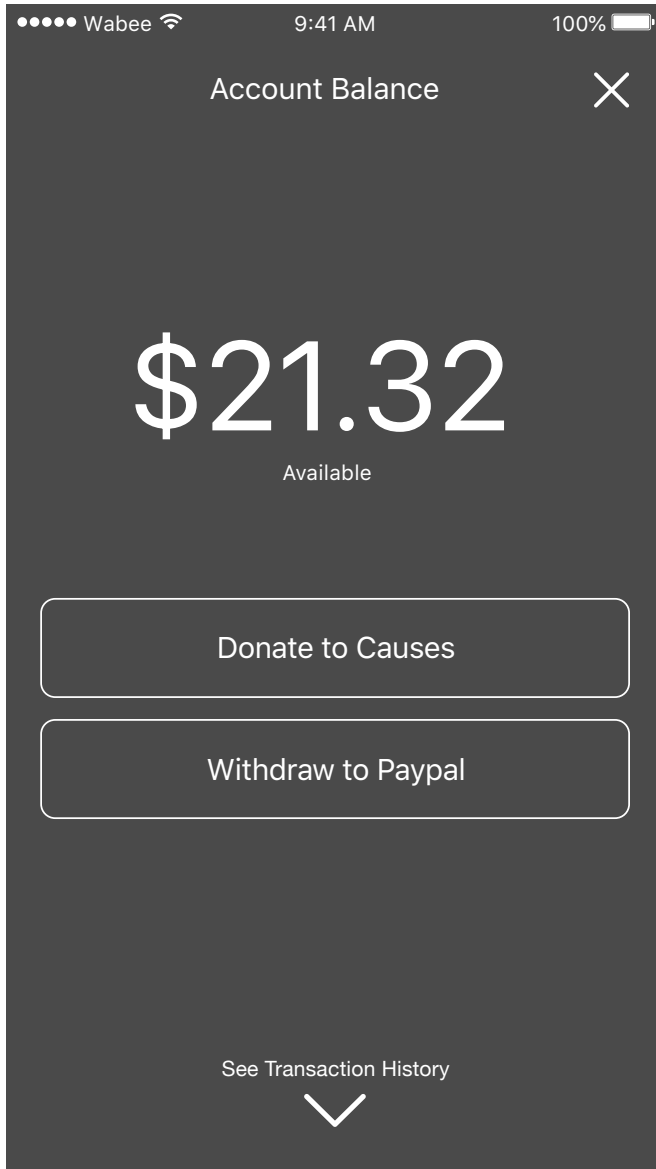

Withdraw to PayPal

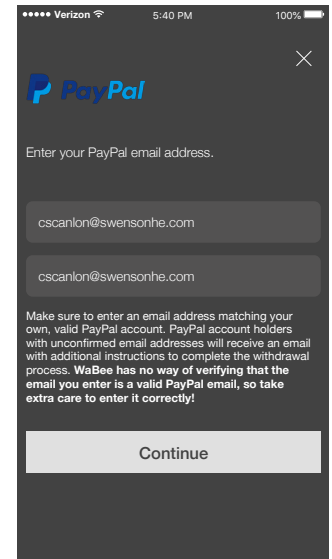
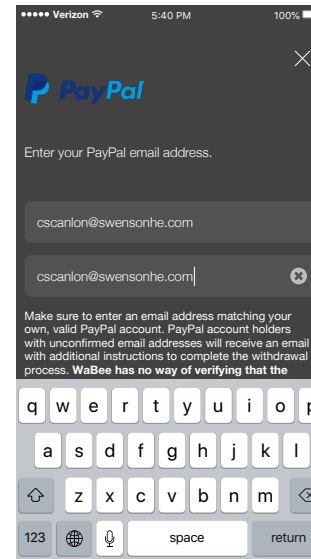
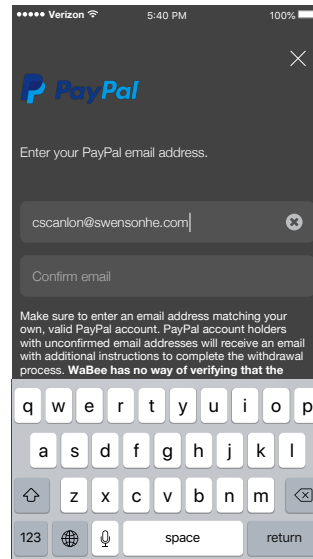
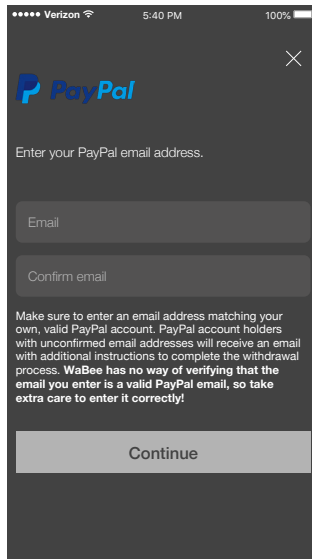
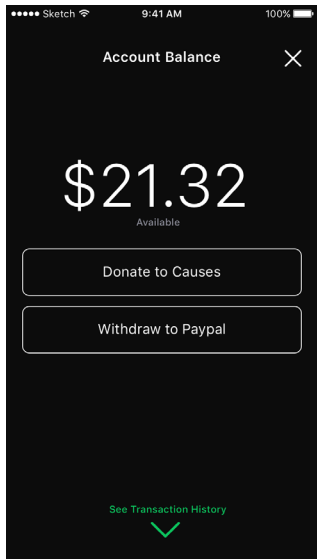

If user has withdrawn before, the first "email" field will be pre-filled with the previously used email address

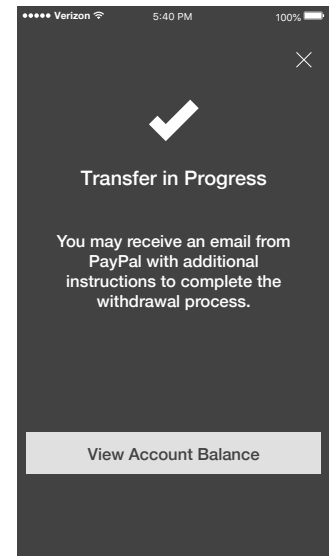
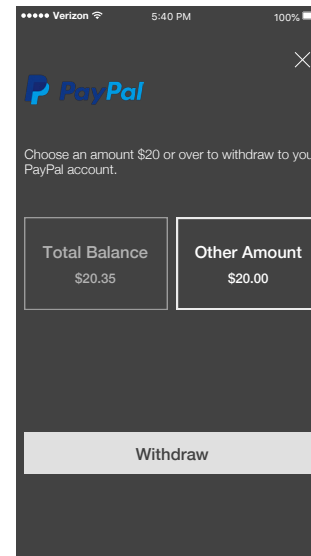
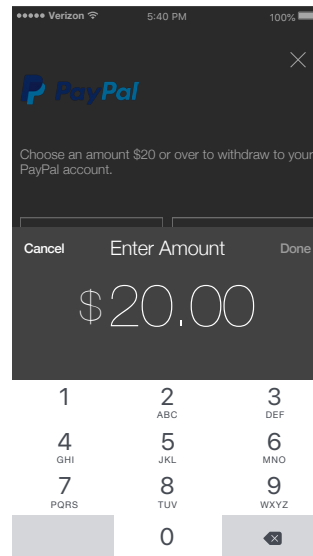
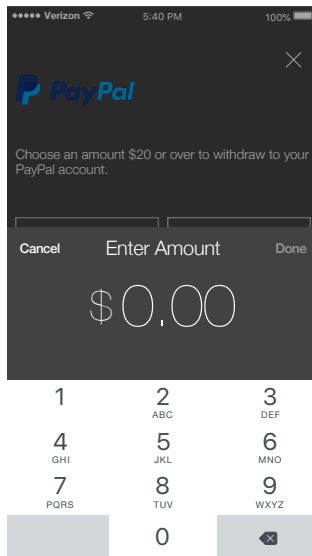
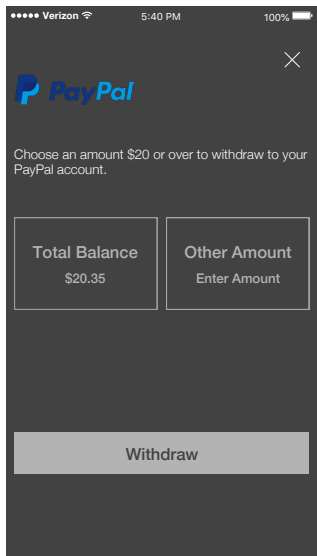

When user taps on "other amount" it brings up the number keyboard

Withdraw to PayPal (errors)

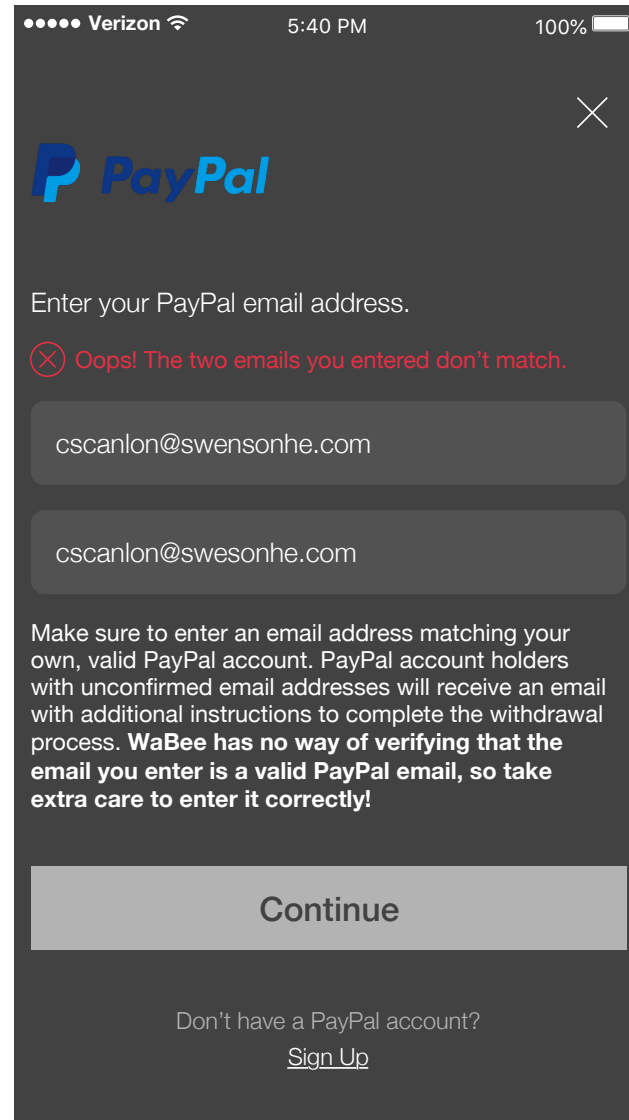
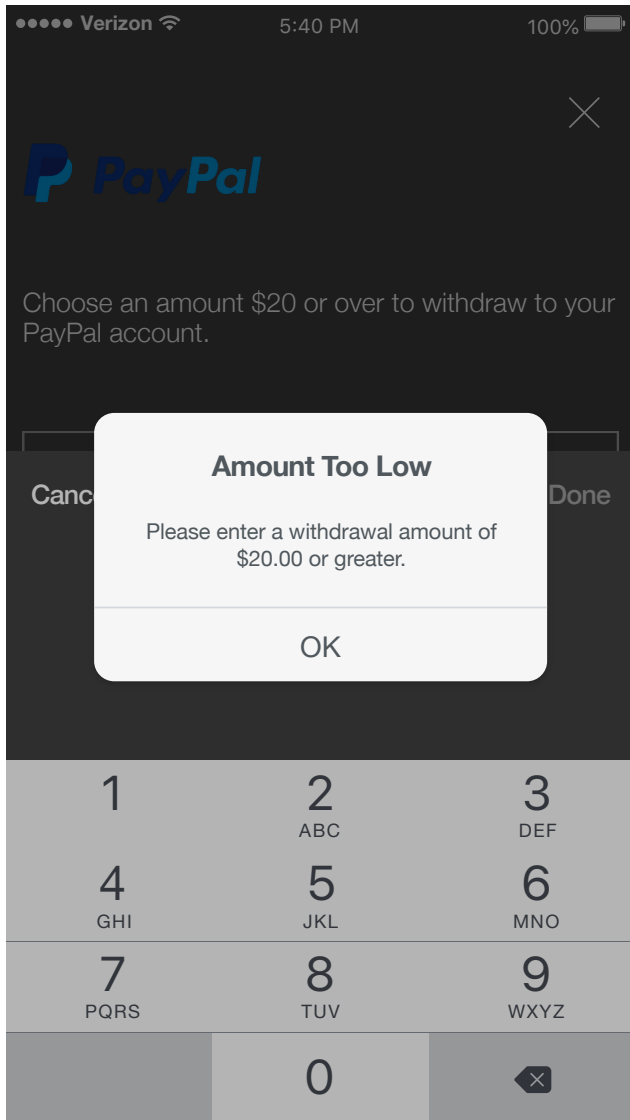

Upload Receipt (1)

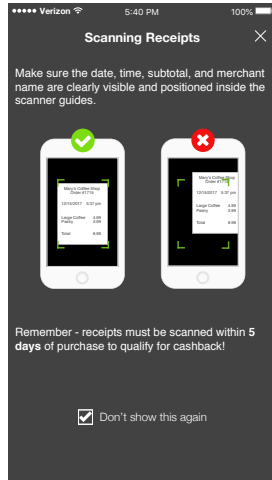
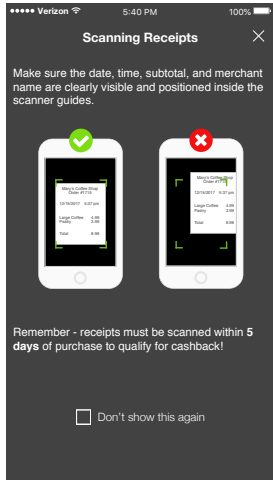

If checkbox is checked, this screen will always be skipped going forward

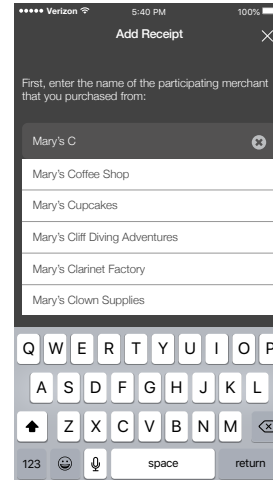
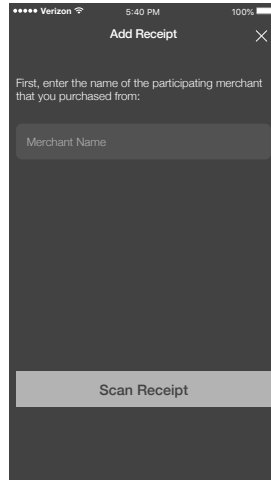

Only merchants in database will show as options

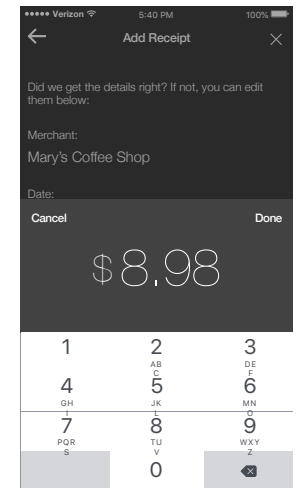
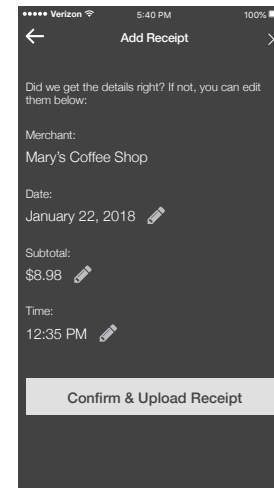
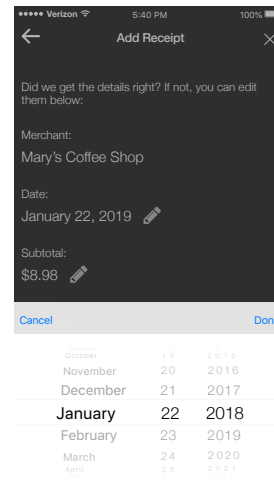
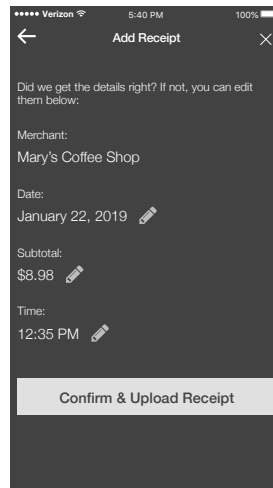
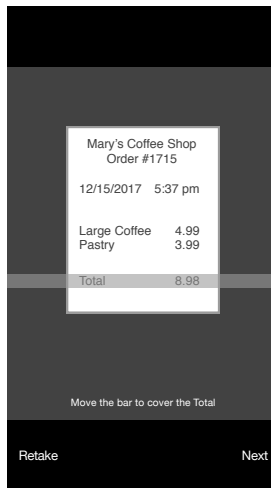
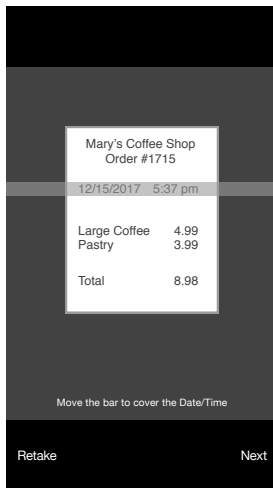
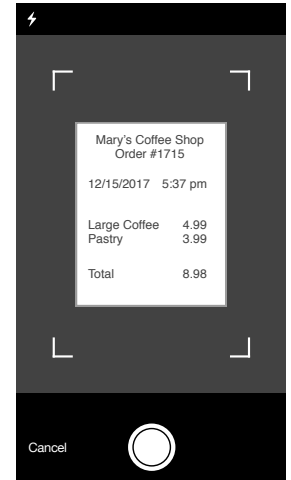
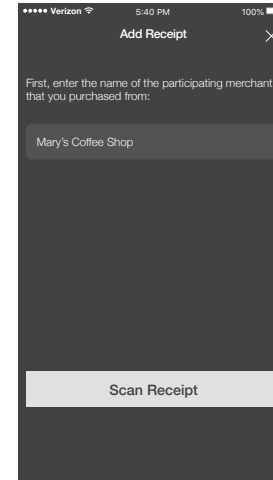

Upload Receipt (2)

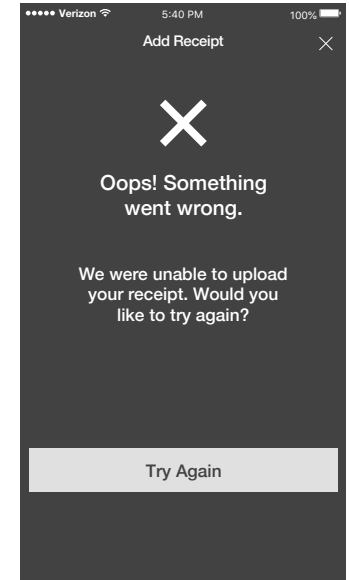
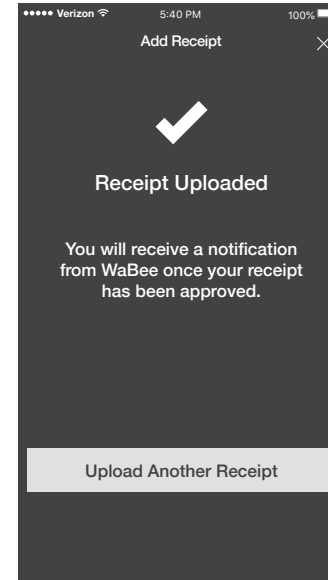
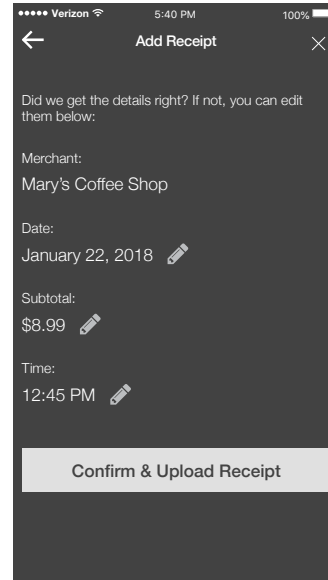
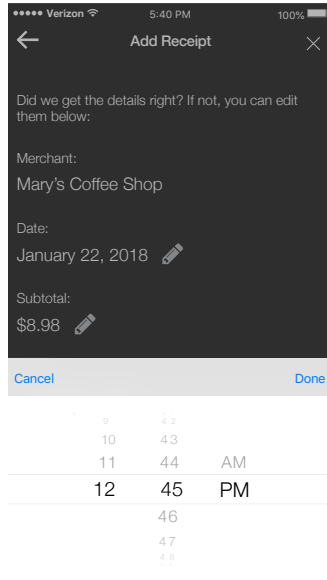
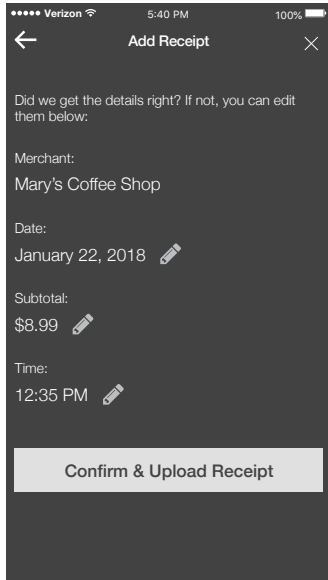

Upload Receipt (Unable to Read)

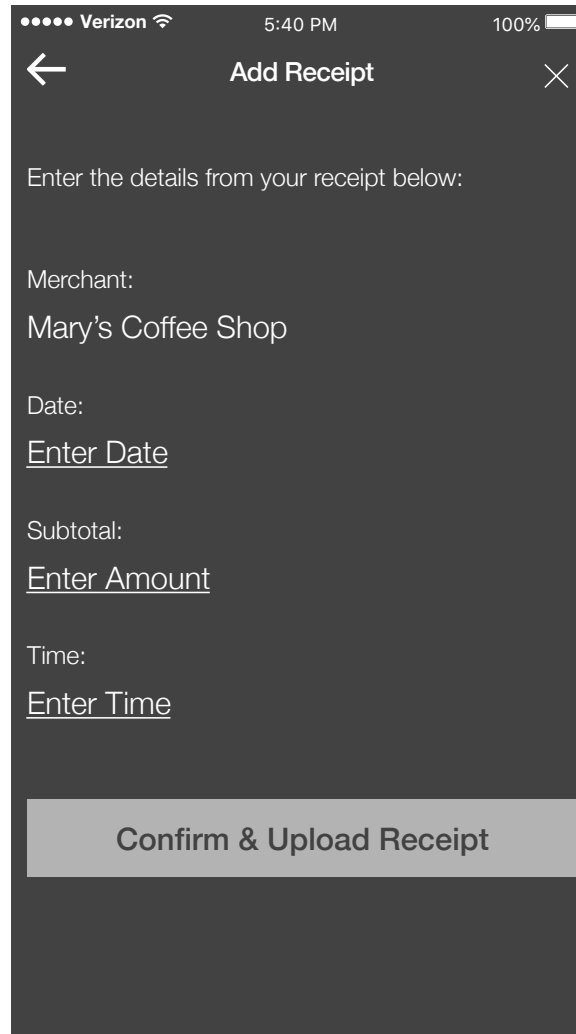

Notifications

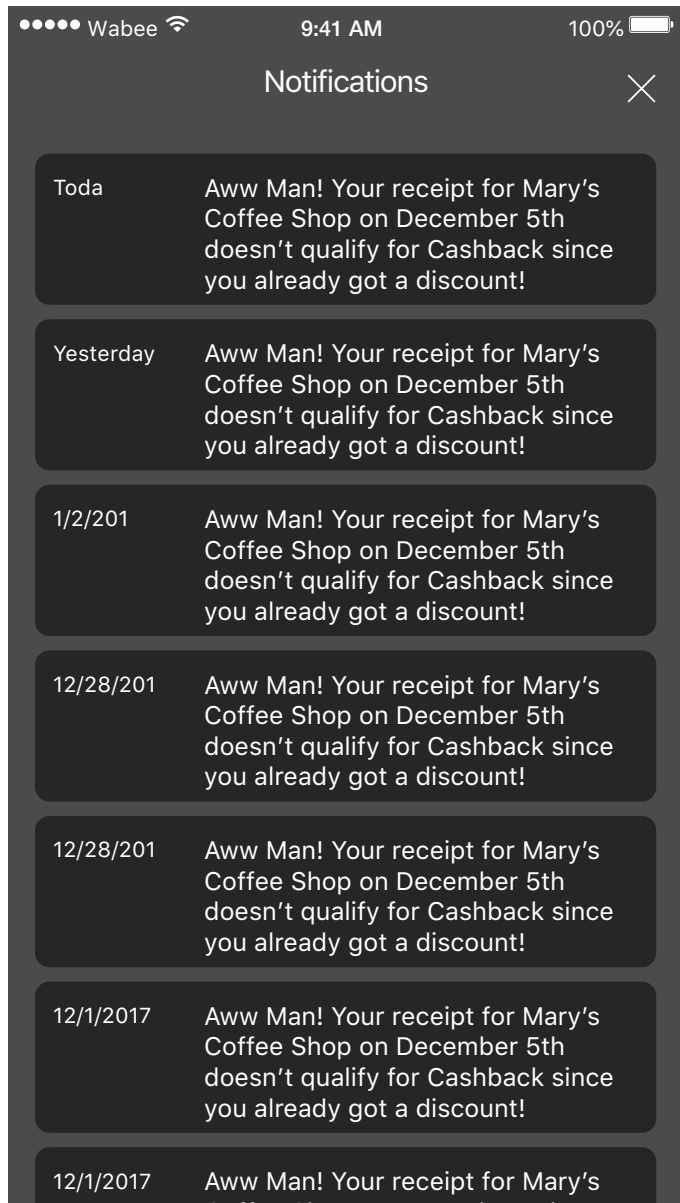

Account

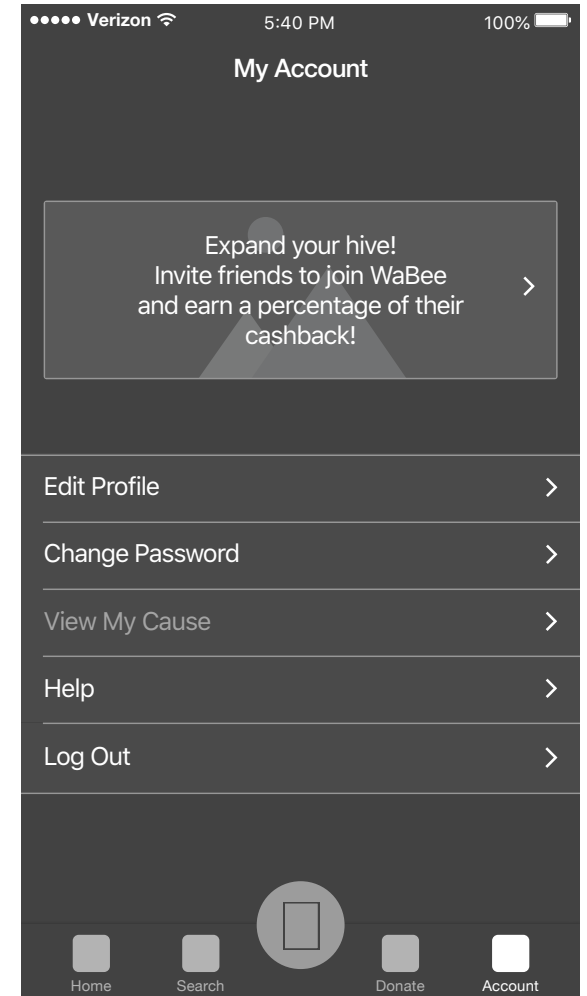
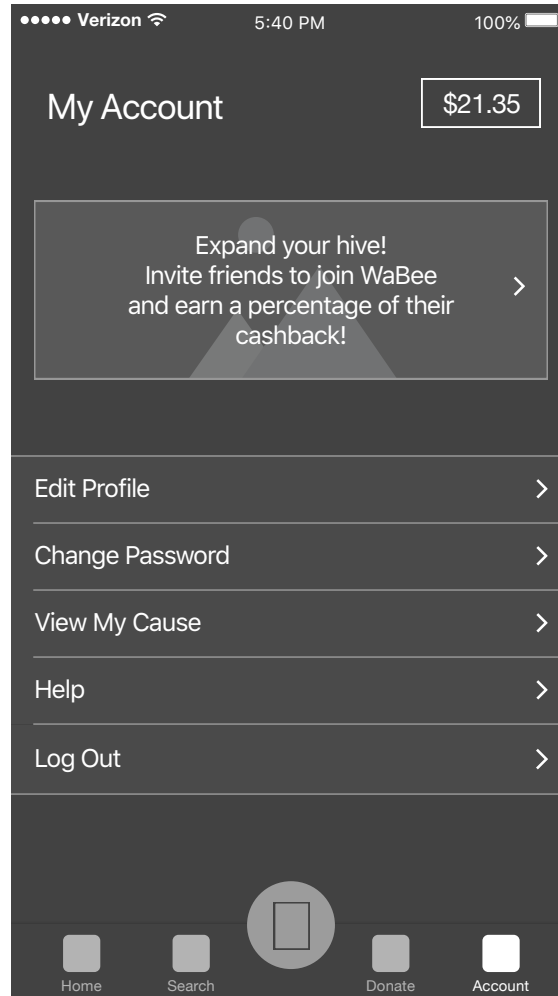
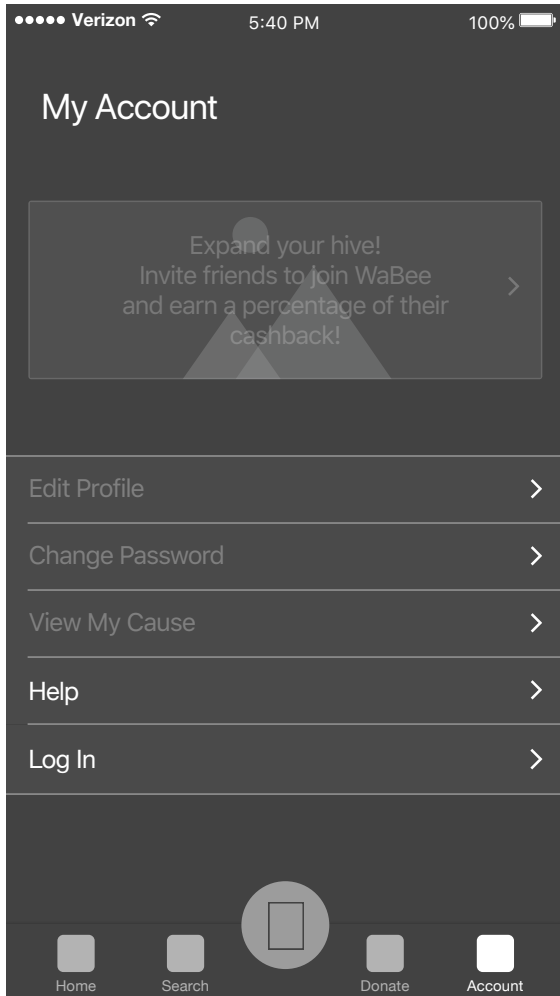

Invite Friends

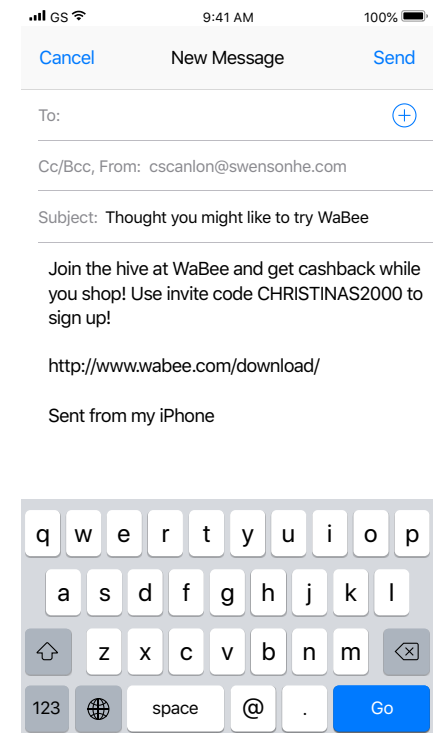
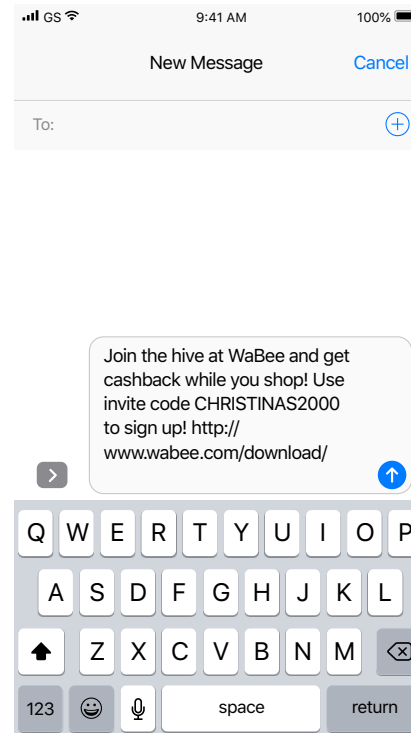
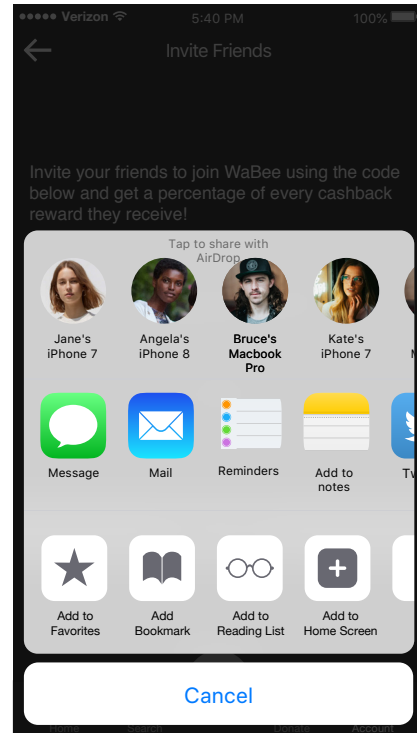
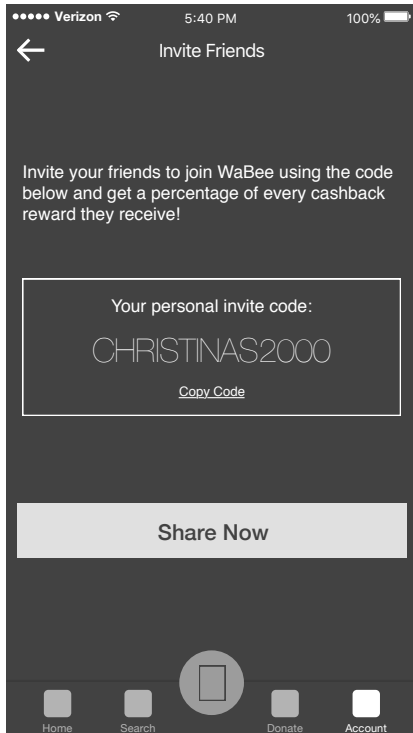

Edit Profile (Photo)

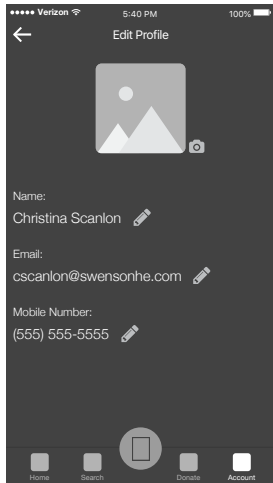

When the user taps camera icon, it opens up iOS photos. The user must choose a specific photo by tapping on it.

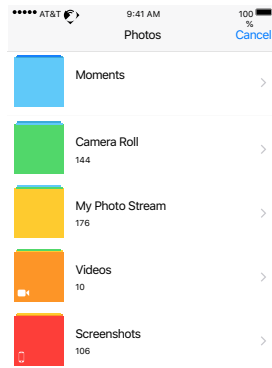

User can drag and scale the image as needed. User cannot scale the image smaller than the boundaries of the box.

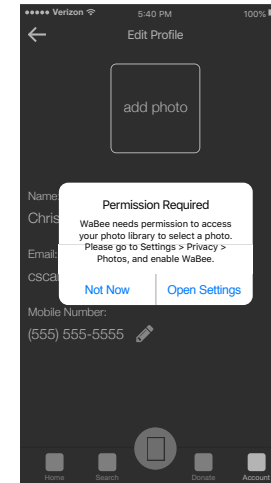
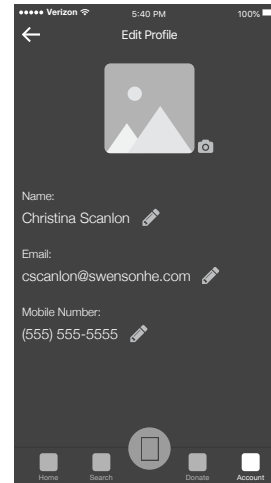

Error if user has denied access to their photo library

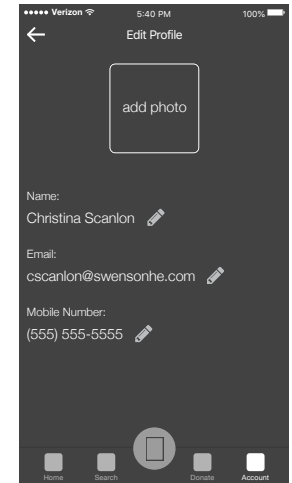

Profile screen if user has never added a photo

Edit Profile (Name, Email)

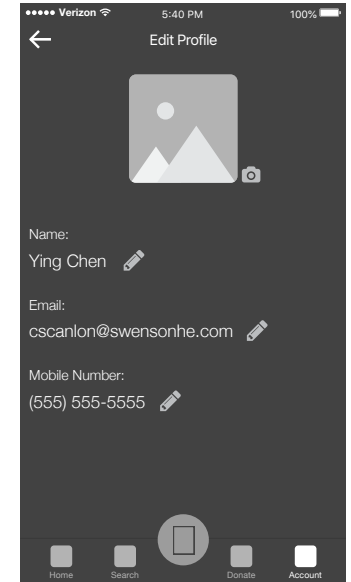
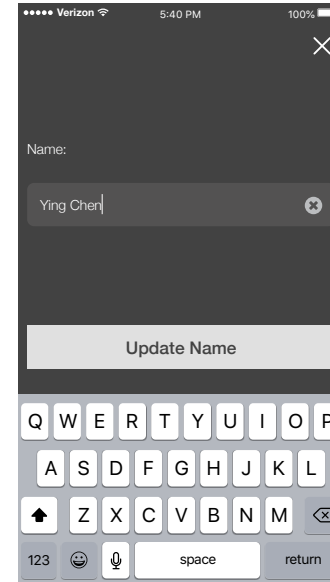
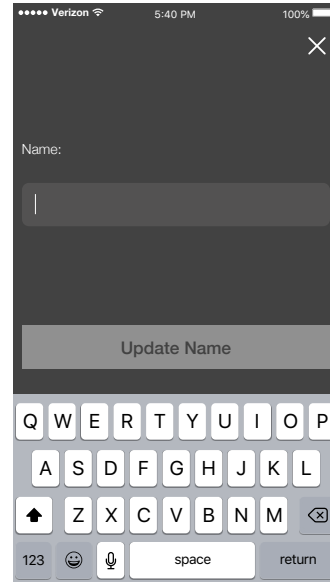
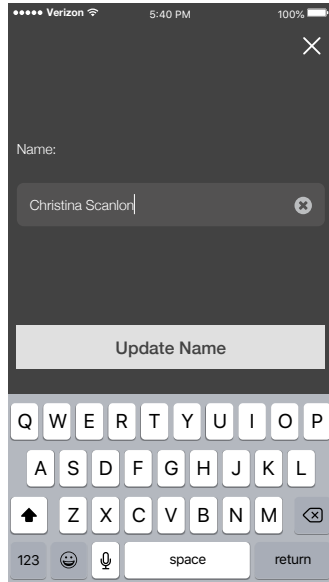
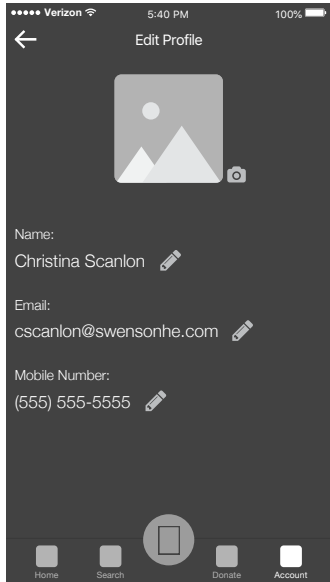

Button is greyed out if field is blank

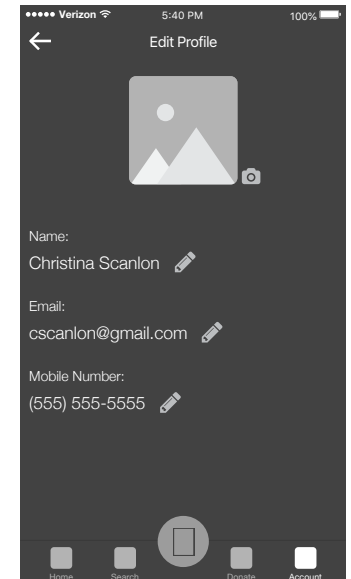
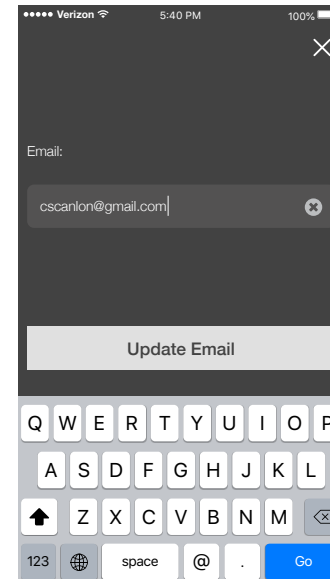
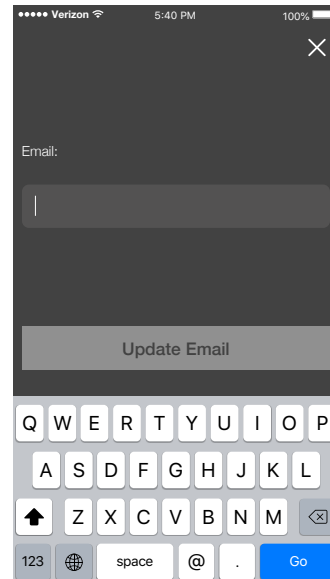
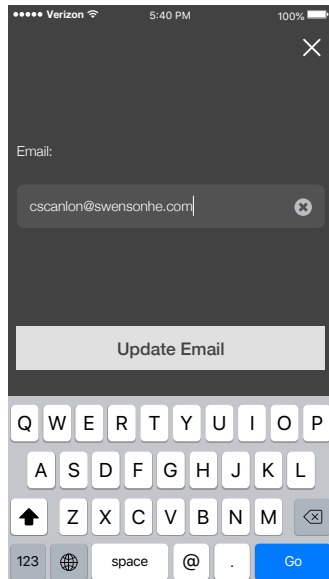
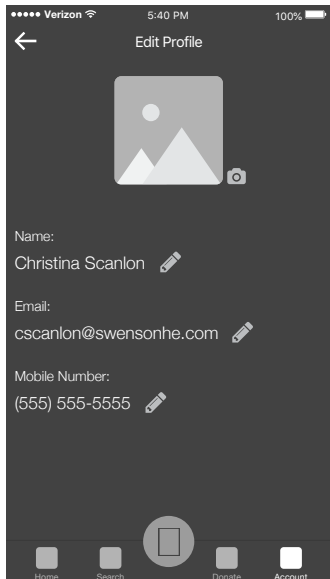

Email keyboard

Button is greyed out until a complete email address is entered

Edit Profile (Mobile #)

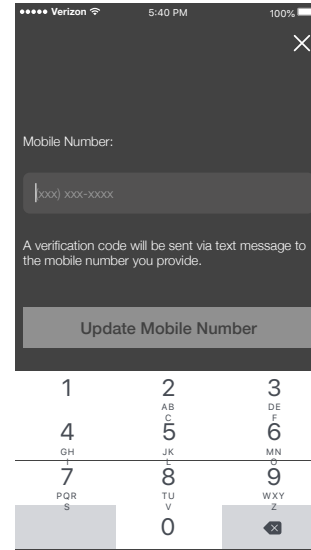
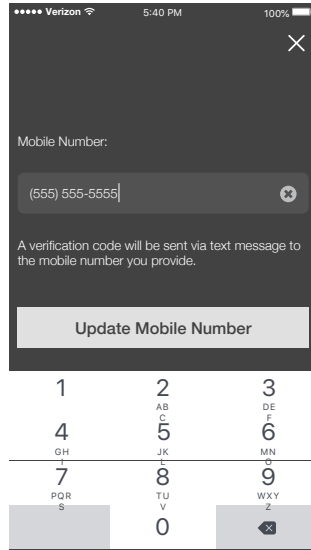
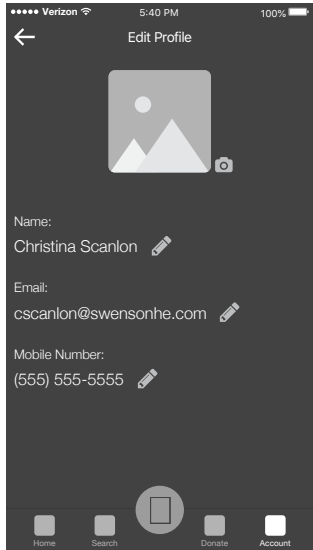

Button is greyed out until complete mobile number is entered

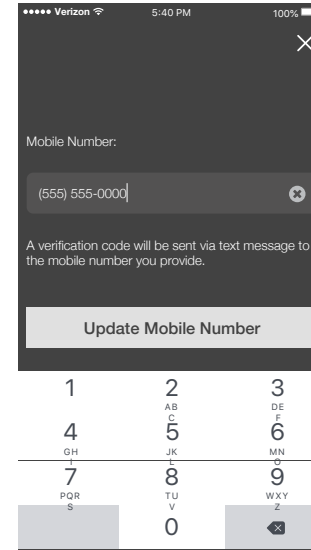

Mobile number is automatically formatted with () and - as user types

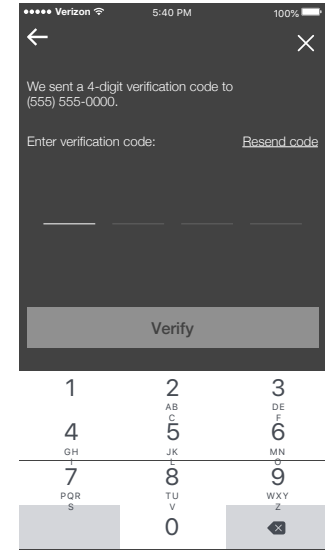

The highlighted line is the next number the user has to type in

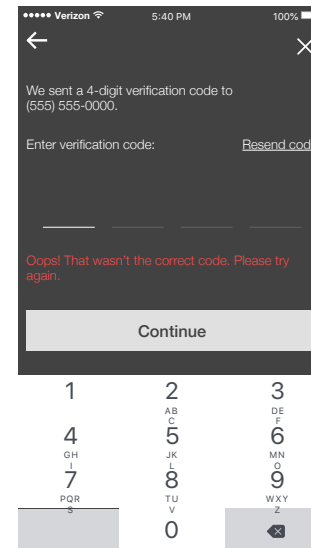
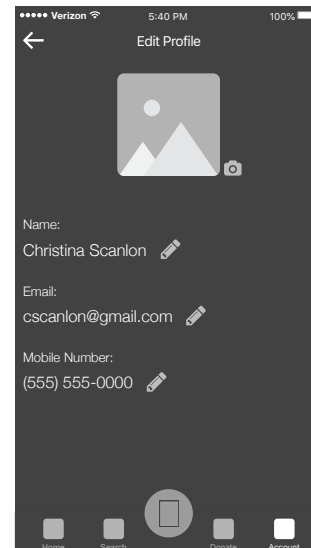
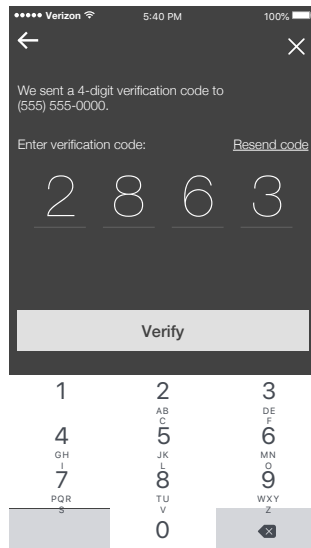
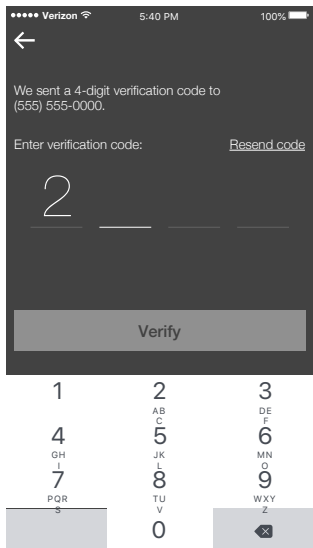

Error if user enters wrong code

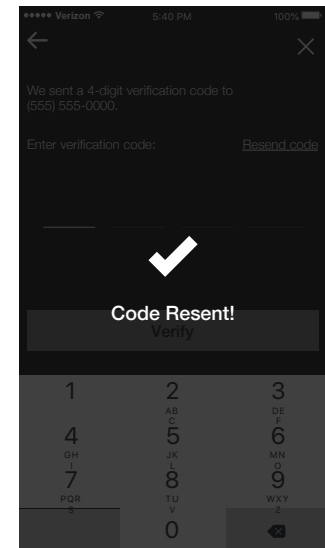

Confirmation after user taps "resend code". Overlay fades out after a second or two.

Change Password

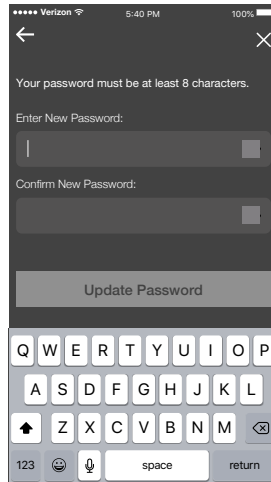
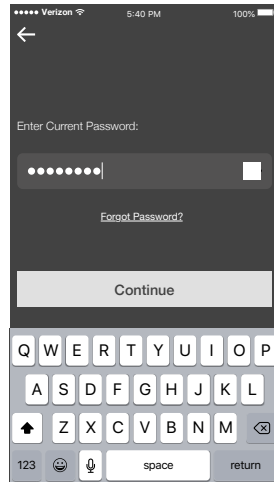
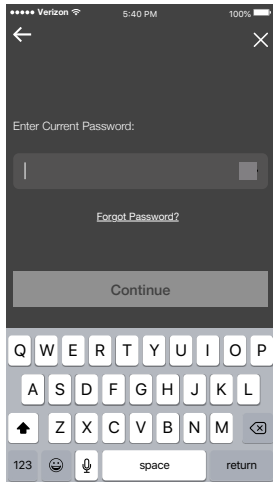

Button is greyed out until user types 8 characters in both fields

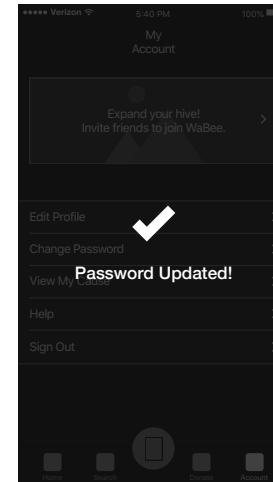
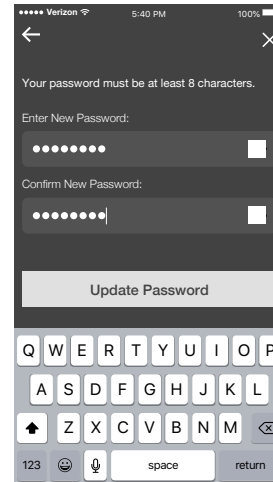

Overlay fades out after a second or two

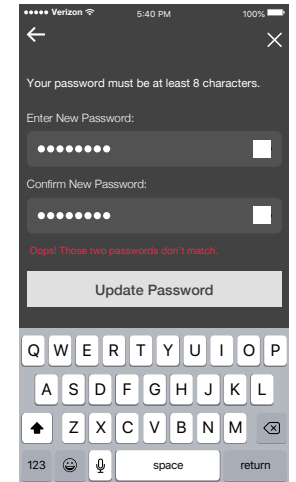

Help

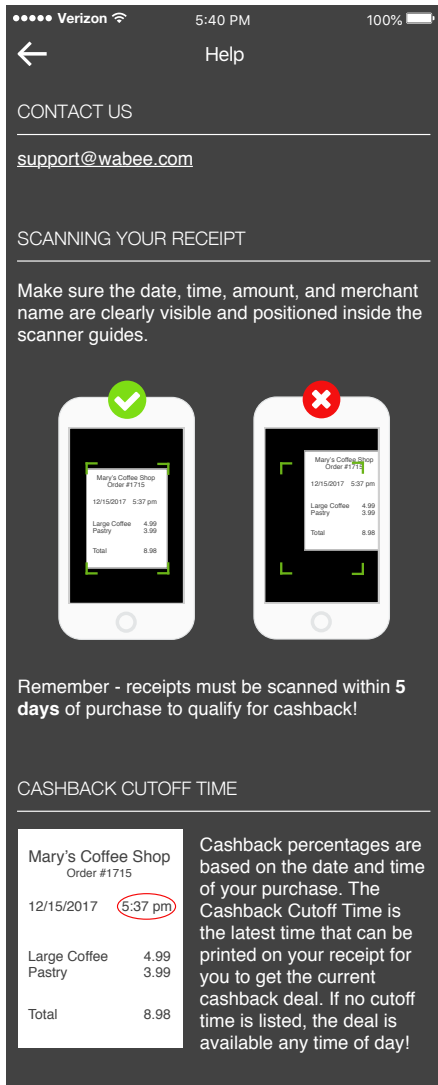

Longer view

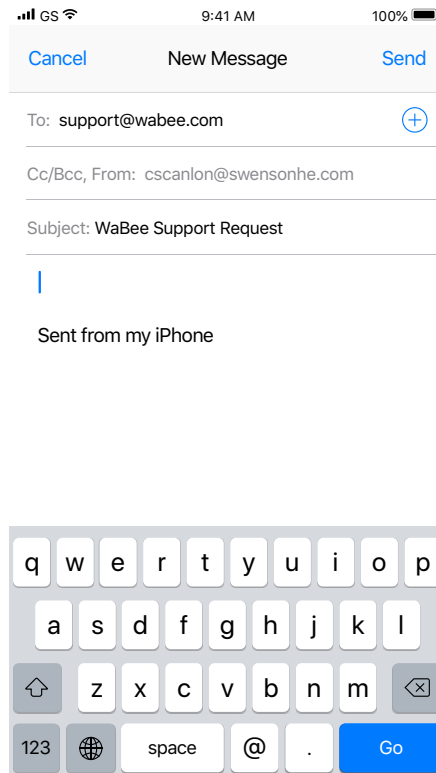

When user taps the support email, it automatically opens up a new email to WaBee support.

Log Out

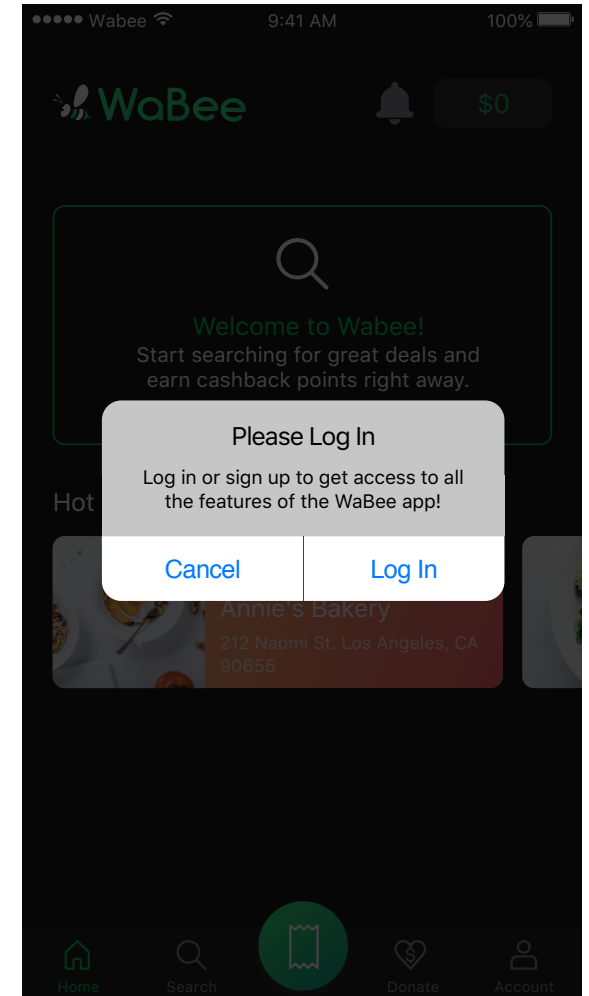
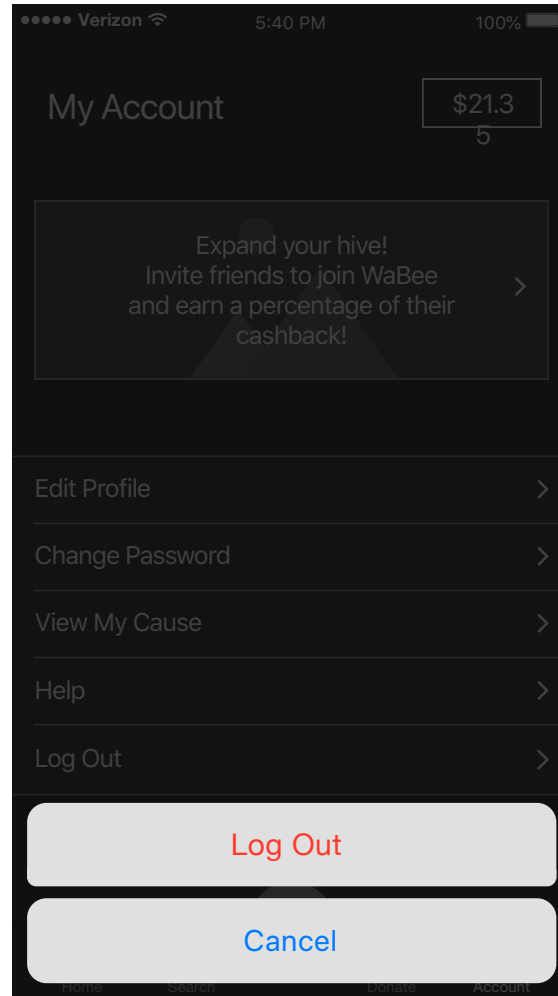
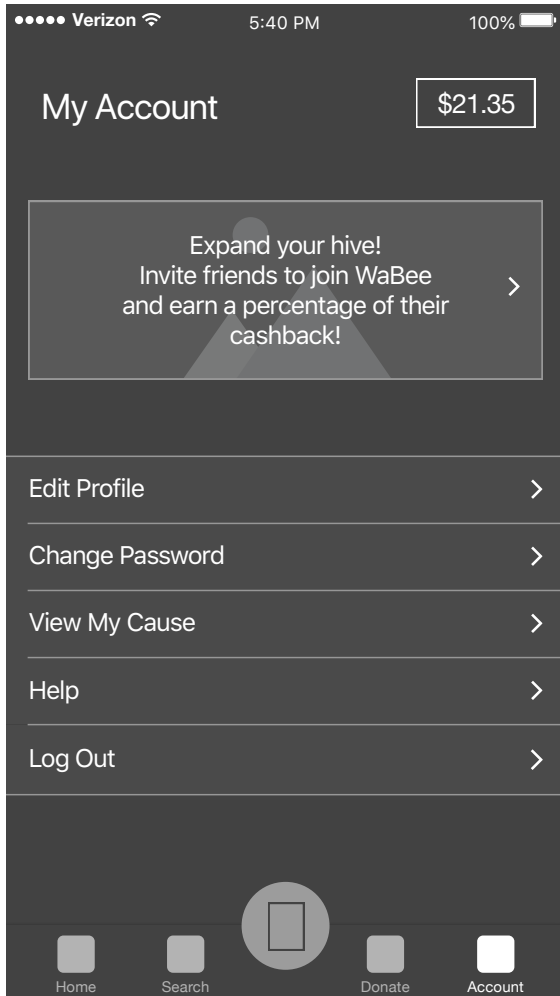

If user taps the account icon (or any function of the app that requires being logged in) but they are not logged in, they would get this error message

Sign Up (1)

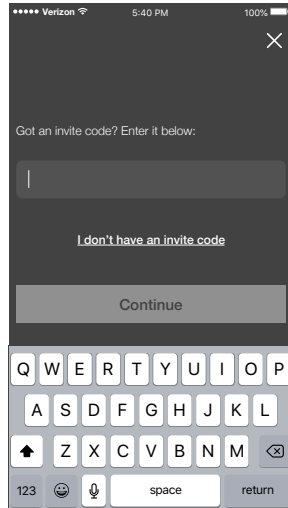
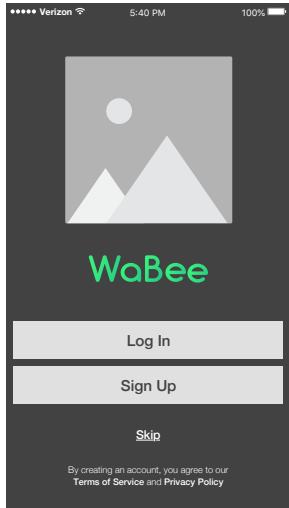

If user taps "I don't have an invite code" they skip to the next step (enter mobile number)

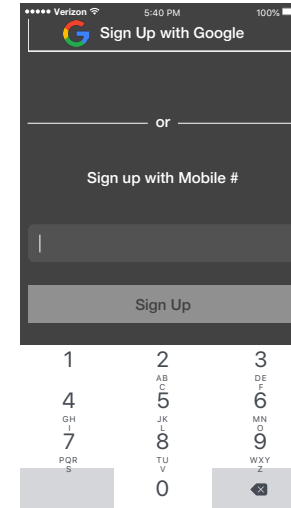
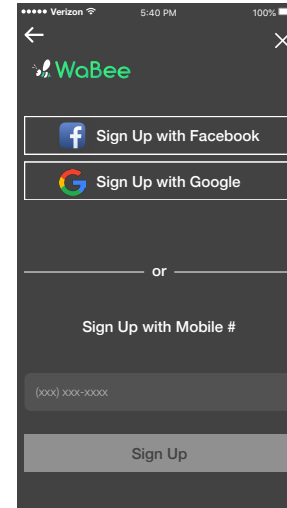
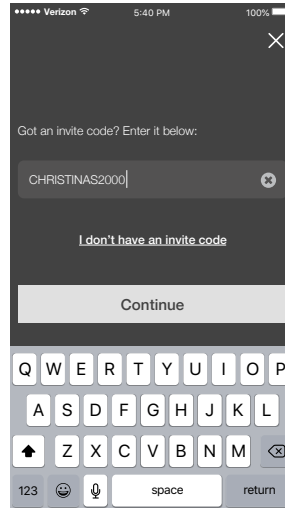

Button is greyed out until user types a complete email address

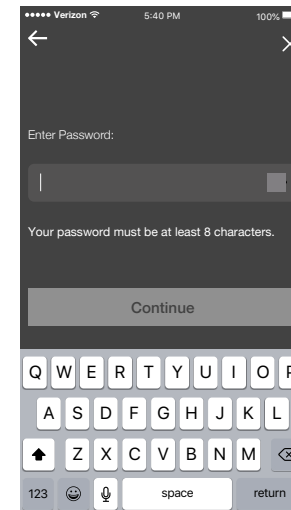
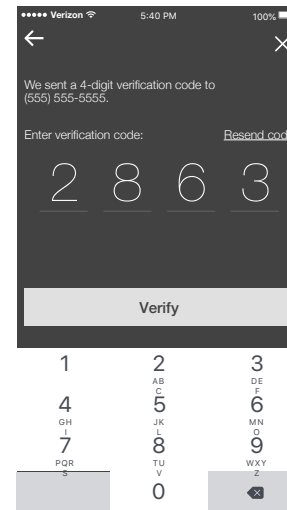
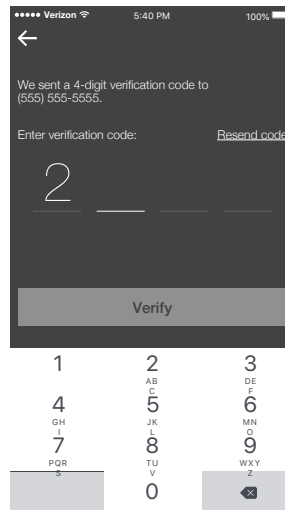
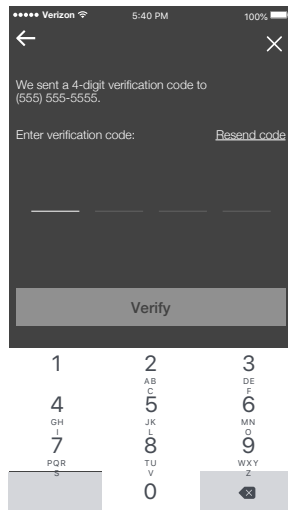
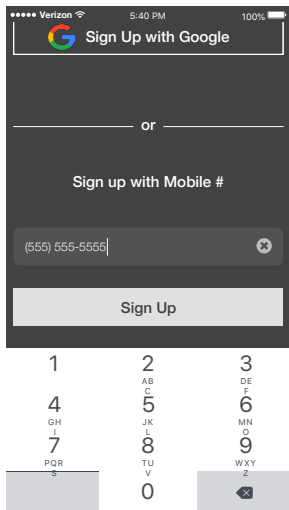

The highlighted line is the next number the user has to type in

Sign Up (2)

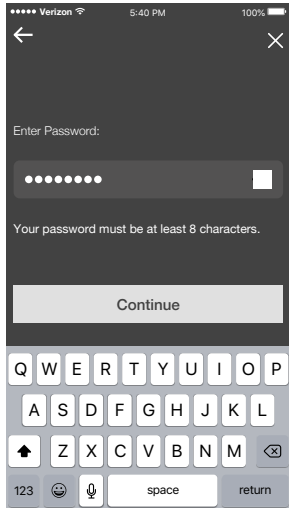

Button is active after user types 8 characters

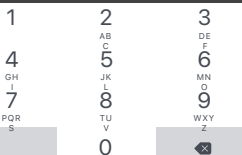
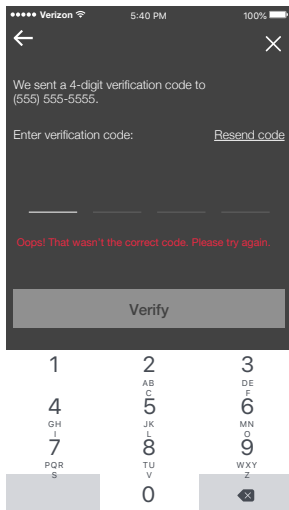
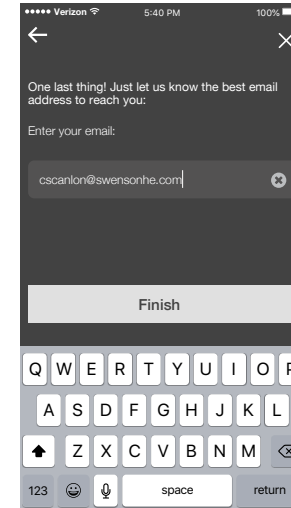
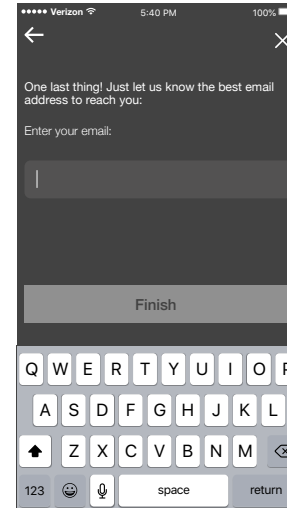
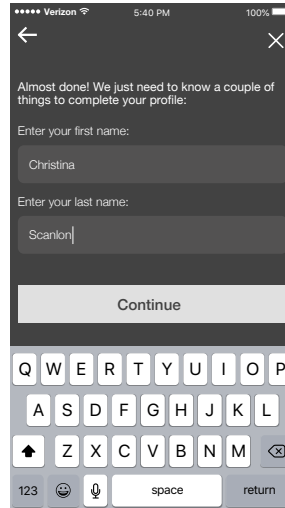
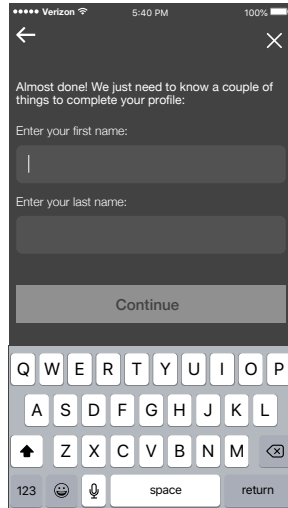

Log In

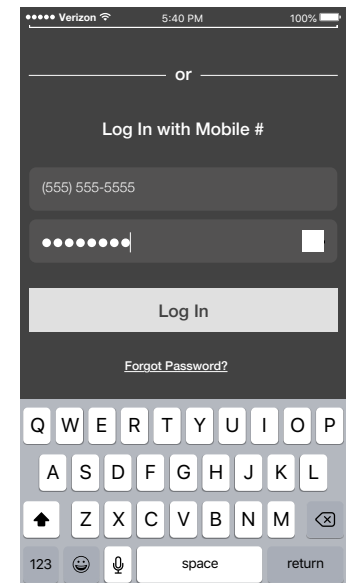
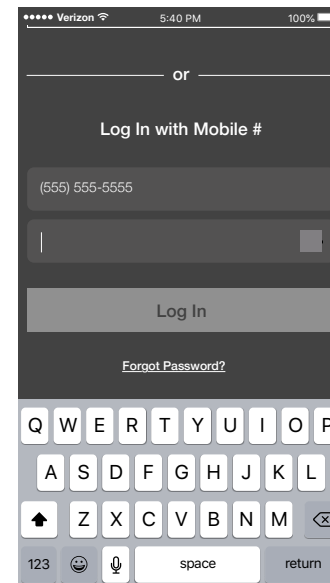
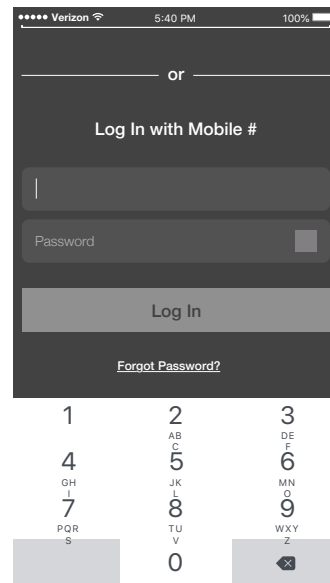
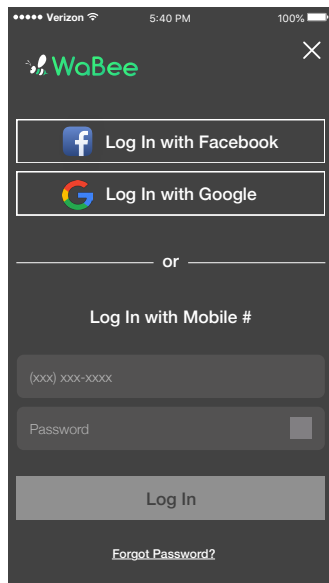
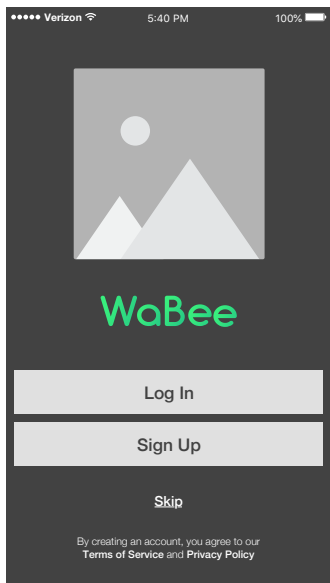

Forgot Password

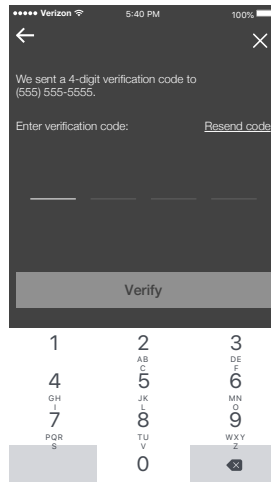
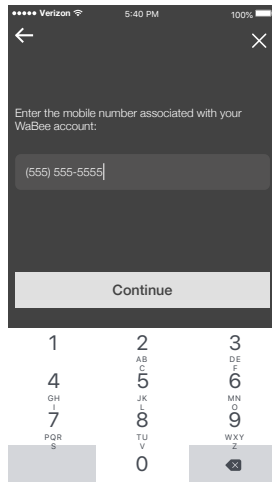
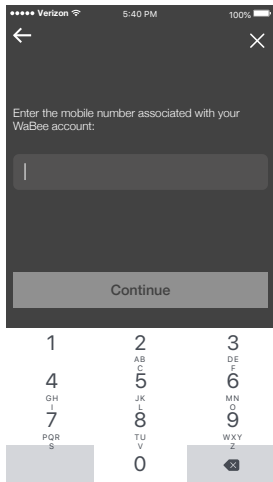

The highlighted line is the next number the user has to type in

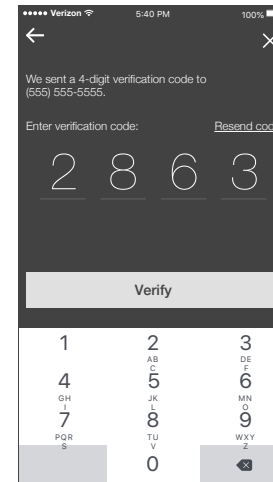
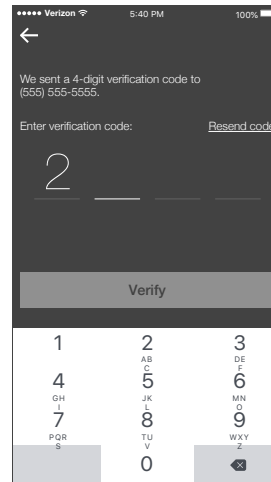

If code is correct, user goes to home screen

